

Beltwide Cotton Conferences

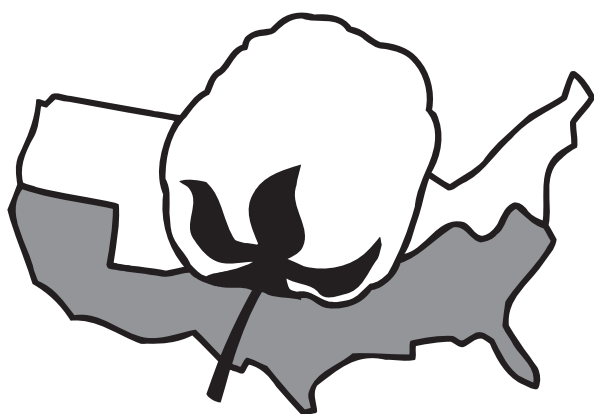

January 4-6, 2022
San Antonio Marriott Rivercenter
San Antonio, TX

**National
Cotton
Council** 
OF AMERICA

Schedule of Events



FARM CREDIT

Thanks to Farm Credit, our Final Program Sponsor

Tuesday, January 4, 2022		
7:00a–10:00p	Speaker Practice Room	Conf. Room 6
9:00a–5:00p	Conference Registration (Sponsored by Bayer)	Registration Desk on Level 2
9:00a–5:00p	Newsroom	Conference Room 5
9:00a–5:00p	Confex Presentation Uploading Room for Speakers	Conference Room 18
11:00a–12:00p	Consultants Conference Luncheon	Conf. Rooms 20-21
12:00p–5:30p	Consultants Conference General Session	Salon G & Corridor
3:00p–3:30p	Coffee Break	Salon E Foyer
3:00p–4:00p	National Cotton Variety Testing Panel Meeting (By Invitation Only)	Conf. Room 14
6:00p–7:00p	Welcome Reception for all attendees	Salons H-I

Wi-Fi

Address: Beltwide Wi-Fi

Password: beltwide2022



Special thanks to the **GEORGIA FARM BUREAU** for providing the peanuts in the registration area.

<http://www.gfb.org>

Schedule of Events

Wednesday, January 5, 2022		
7:30a–5:00p	Speaker Practice Room	Conf. Room 6
7:30a–5:00p	Conference Registration (Sponsored by Bayer)	Registration Desk on Level 2
7:30a–5:00p	Newsroom	Conference Room 5
7:30a–5:00p	Confex Presentation Uploading Room for Speakers	Conference Room 18
8:00a–12:00p	Consultants Conference General Session	Salon G & Corridor
8:00a–12:30p	Joint Session: Improvement, Disease, and Insect Conferences	Salon I
8:00a–12:00p	Cotton Weed Science Research Conference (Sponsored by Valent)	Salon J
8:00a–5:00p	Cotton Sustainability Conference (Sponsored by Valent)	Salon L
8:00a–12:00p	Cotton Agronomy, Physiology & Soils Conference – Student Competition (Sponsored by John Deere)	Salon M
8:00a–7:00p	Cotton Agronomy, Physiology & Soils Conference 5:15-7:00p – Business Meeting (Sponsored by John Deere)	Salon A
8:00a–10:00p	Poster Board Session	Salon E
8:30a–11:00a	NCGA Member Association Meeting	Conf. Room 14
10:00a–10:30a	Coffee Break	Salon E Foyer
10:30a–12:00p	Cotton Economic Outlook Symposium	Salon F & Corridor
10:30a–12:00p	Cotton Utilization Conference	Conf. Room 8
11:00a–12:00p	Cotton Insect Conf. Roundtable	Salons CD
1:00p – 5:30p	Cotton Engineering-Systems Conference (Sponsored by John Deere)	Conf. Room 13
1:00p – 5:00p	Cotton Agronomy, Physiology & Soils Conference – Student Competition (Sponsored by John Deere)	Salon M
1:00p–7:00p	Cotton Disease Council 5:00-7:00 p.m. – Business meeting	Conf. Room 16-17
1:15p– 5:00p	Cotton Improvement Conference	Salon I
1:30p–5:30p	Cotton Insect Research & Control Conf. – Ph.D. Student Comp. & Session A	Salons CD
1:30p–5:30p	Cotton Insect Research & Control Conf. – M.S. Student Comp. & Sessions B & C (mixer in same room from 5:30-7:00 p.m.)	Salon G & Corridor
1:30p – 5:05p	Cotton Ginning Conference (Sponsored by Tama)	Salon K

Schedule of Events

Wednesday, January 5, 2022		
1:30p–5:00p	Cotton Economics and Marketing Conference (4 poster presentations)	Salon F & Corridor
3:15p–4:00p	Coffee Break in Poster Board Session room (authors present)	Salon E
2:15p–5:00p	Cotton Quality Measurements Conference (Sponsored by John Deere)	Conf. Room 8
5:15p–7:00p	Cotton Agronomy & Physiology Business Meeting	Salon A
5:30p–7:00p	Cotton Insect Research & Control Business Meeting and Mixer (Sponsor: Bayer Crop Science)	Salon G
6:00p–7:00p	Cotton Industry Support Group Meeting	Salon K
6:00p–7:00p	Journal of Cotton Science Editorial Board	Conf. Room 3
7:00p–9:00p	Joint Cotton Breeding Committee	Conf. Room 4

Schedule of Events

Thursday, January 6, 2022		
7:00a- 12:00p	Speaker Practice Room	Conf. Room 6
7:30a- 8:00a	Coffee Break	Salon E Foyer
7:30a- 1:00p	Conference Registration	Registration Desk, Level 2
7:30a- 1:00p	Newsroom	Conf. Room 5
7:30a- 1:00p	Confex Presentation Uploading Room for Speakers – CLOSED – (presenters go to meeting rooms to upload)	Conf. Room 18
8:00a- 10:30a	Cotton Insect Research & Control Conf. – Session B	Salon G & Corridor
8:00a- 10:30a	Cotton Insect Research & Control Conf. – Session C	Salons CD
9:00a- 10:30a	Cotton Agronomy, Physiology & Soils Conference – Awards (Sponsored by John Deere)	Salon A
8:00a- 10:00a	Joint Session: Cotton Ginning Conference and Cotton Engineering Systems Conference (Sponsored by Tama and John Deere)	Salon K
8:00a- 12:00p	Poster Board Session	Salon E
8:00a- 12:00p	Cotton Disease Council	Conf. Rooms 16-17
8:00a- 8:30a	Cotton Improvement Conference Business Meeting	Conf. Room 14
8:00a- 10:00a	Cotton Sustainability Conference (Sponsored by Valent)	Salon L
9:00a- 12:00p	Cotton Agronomy, Physiology & Soils Conference (Sponsored by John Deere)	Salon M
9:45a- 10:15a	Weed Science Conference Graduate Student Awards	Salon J
10:00a- 10:30a	Coffee Break	Salon E Foyer

CEU Information

BWCC attendees are encouraged to seek CEU credits from the appropriate agency based on an individual's level of participation in BWCC programs.

The CEU application process is now tailored to the CEU requirements of each certifying entity (state regulatory authority or association certifier). Until recently, the application process across entities was relatively uniform. However, application processes have diverged to the extent that it is no longer feasible for BWCC staff to provide blanket CEU application services. BWCC staff will submit the final BWCC program to those states and agencies listed below that may accept the BWCC Technical Conferences program for CEU evaluation. It is up to individuals to submit their application to their desired accreditation authority.

Accrediting Group or State
Certified Crop Adviser (CCA) Program American Society of Agronomy (Soil Science Society of America), 5585 Guilford Road, Madison, WI 53711-5801 (National) Certification Representative--Certification Programs; Phone: 608-268-4953; Fax: 608-273-2081; Toll Free Number: 866-359-9161; Email: ledwardson@sciencesocieties.org
Alabama Department of Agriculture & Industries, Pesticide Management ~ Certification Unit; 1445 Federal Drive, Montgomery, AL 36107; Phone: 334-240-7240; Fax: 334-240-7168; Email: Barbara.gates@agi.alabama.gov
Arizona Department of Agriculture, Office of Pest Management; 1688 West Adams, Phoenix, AZ 85007; Phone: 602-255-3662; Email: rwalker@azda.gov
Arkansas Charles E. Denver, Denver Crop Consultants; P.O. Box 304, Watson, AR 71674; Phone: 870-866-2335; Fax: 870-644-3254; Email: cdagri@hotmail.com
California Department of Pesticide Regulation; P. O. Box 1379, Sacramento, CA 95812; Phone: 916-445-3914; Fax: 916-928-0705; Email: info4ce@cecpm.com
Georgia Department of Agriculture; 19 Martin Luther King, Jr. Dr., Room 410, Atlanta, GA 30334; Phone: 404-656-4960; Fax: 404-657-8378; Email: Adrean.Rhodes@agr.georgia.gov
Louisiana Department of Agriculture & Forestry, Office of Agricultural & Environmental Sciences; 5825 Florida Blvd. Ste. 3003, Baton Rouge, LA 70806-4259; Phone: 225-925-3763; Fax: 225-237-5725; Email: kevin_w@ldaf.state.la.us; Web: www.ldaf.state.la.us
Mississippi Department of Agriculture & Commerce, Bureau of Plant Industry, Pest Control Section; P.O. Box 5207, Mississippi State, MS 39762; Phone: 662-325-0522 or 662-325-7766; FAX: 662-325-0397; Email: russellk@mdac.ms.gov (or) AnnaA@mdac.ms.gov
New Mexico Department of Agriculture, Cert. & Training Specialist; 190 S. Espina, MSC 3AQ, Box 30005, Las Cruces, NM 88003-8005; Phone: 575-646-4837; FAX: 575-646-1540; Email: pesticides@nmda.nmsu.edu
North Carolina Pesticide Section, NCDA & CS; 1090 Mail Service Center, Raleigh, NC 27699-1090; Phone: 919-857-4133; FAX: 919-733-9796; Email: John.Feagans@ncagr.gov

Oklahoma Pesticide Certification & Training Administrator, Agriculture, Food and Forestry, Consumer Protection Services;
2800 N. Lincoln Blvd., Oklahoma City, OK 73105;
Phone: 405-522-5993; Fax: 405-522-5986;
Email: ryan.williams@ag.ok.gov

South Carolina Special Programs Manager/Recertification Manager
Department of Pesticide Regulation
Division of Regulatory & Public Service Programs
511 Westinghouse Road, Pendleton, SC 29670;
Phone: 864-646-2150; Fax: 864-646-2179;
Email: thghslr@clemson.edu

Tennessee Department of Agriculture, Ellington Ag. Center, Regulatory Services;
440 Hogan Road, Melrose Station, Nashville, TN 37204;
Phone: 615-837-5310; Fax: 615-837-5012;
Email: mary.borthick@tn.gov

Texas Department of Agriculture, Coordinator for Pesticide Certification and Compliance;
P.O. Box 12847, Austin, TX 78711;
Phone: 512-463-7692 or 800-835-5832; Fax: 888-216-9865;
(CEU inquiries) Email: recertcourses@texasagriculture.gov;
Phone: 512-463-8713

Marriott Rivercenter Hotel

Meeting Room Floor Plans

3rd Floor

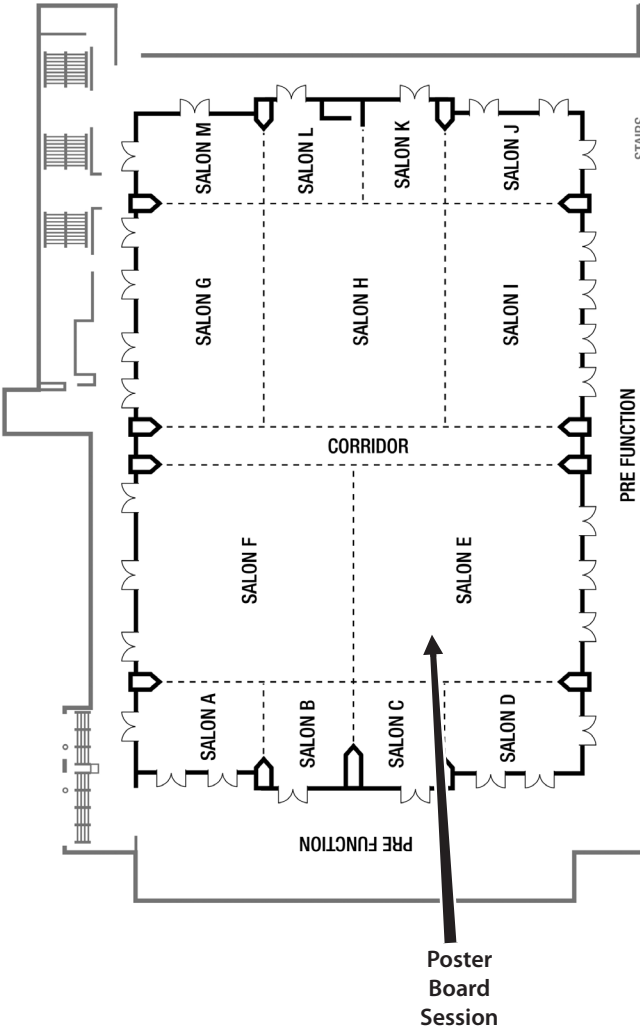

Marriott Rivercenter Hotel

Meeting Room Floor Plans

3rd Floor

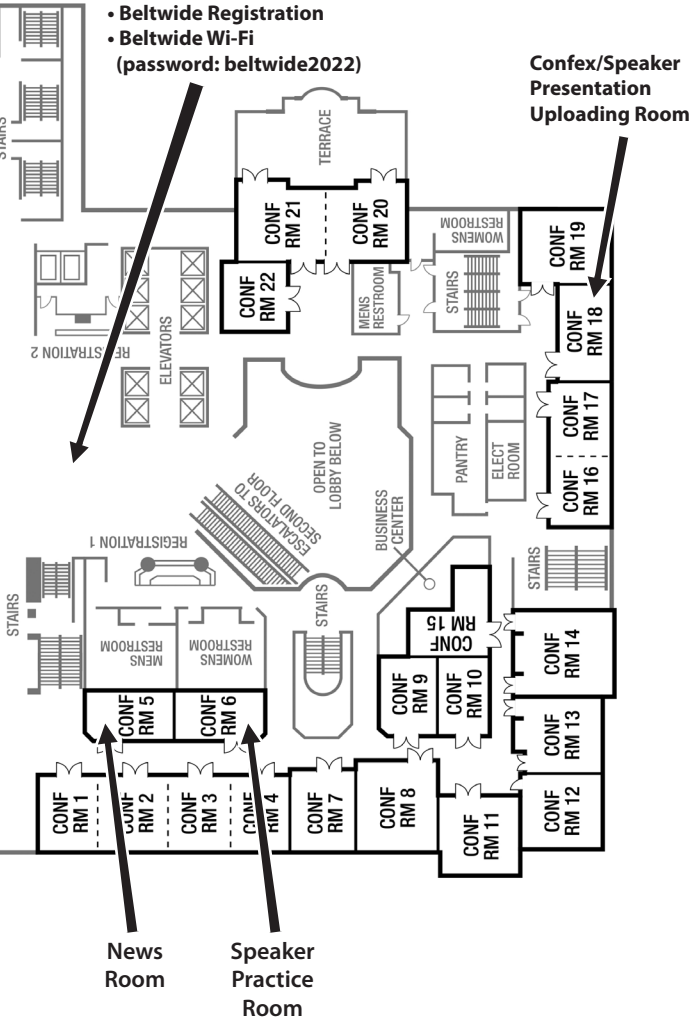

Tuesday, January 4, 2022

Cotton Consultants Conference

**CONSULTANTS CONFERENCE GENERAL SESSION
TUESDAY AFTERNOON**

Salon G - 12:00 PM-5:30 PM

12:00 PM Welcome

Hank Jones, RHJ Ag Services, LLC., Winnsboro, LA

12:05 PM Message from Sponsors - Bayer

David W Albers, Bayer Crop Science, St. Louis, MO

12:10 PM Message from Sponsors - BASF/Fibermex

Steve Nichols, BASF, Lubbock, TX

12:15 PM Message from Sponsors - Corteva/Phytogen

Joel C Faircloth, PhytoGen Seed Company, LLC, Clemmons, NC

12:20 PM Message from Sponsors - FMC

Eric Castner, FMC, Pauls Valley, OK

12:25 PM Message from Sponsors - Syngenta

Macie O'Shaughnessy, Syngenta, Golden Valley, MN

12:30 PM Message from Sponsors - Valent

Jeffrey D Smith, Valent USA LLC, Fayetteville, GA

12:35 PM US Cotton Trust Protocol - Introduction

Gary Adams, National Cotton Council, Cordova, TN

12:50 PM US Cotton Trust Protocol - Buyer Perspective

TBD

1:05 PM US Cotton Trust Protocol - Producer Prospective

TBD

1:20 PM US Cotton Trust Protocol - How Consultants Can Engage

Rogers Leonard, Louisiana State University Ag Center, Baton Rouge, LA and
Hank Jones, RHJ Ag Services, LLC., Winnsboro, LA

1:35 PM Where Do We Go After Bt? - Introduction to Topic

Rogers Leonard, Louisiana State University Ag Center, Baton Rouge, LA

1:50 PM Where Do We Go After Bt? - Contributor

Hank Jones, RHJ Ag Services, LLC., Winnsboro, LA

2:05 PM Where Do We Go After Bt? - ABSTC

David W Albers, Bayer Crop Science, St. Louis, MO

2:20 PM Where Do We Go After Bt? - Academic

Peter C Ellsworth, University of Arizona, Maricopa, AZ

2:35 PM Carbon Sequestration Science

Don Parker, National Cotton Council, Cordova, TN

3:00 PM Break

3:30 PM Weather Risk in US Cotton Production

Eric Snodgrass, Nutrien Ag Solutions, Champaign, IL

4:00 PM Managing ThryvOn - Industry

Timothy Dabbert, Bayer Crop Science, Creve Couer, MO

4:15 PM Managing ThryvOn - Academic

Jeff Gore, Mississippi State University, Stoneville, MS

4:30 PM Managing ThryvOn - Consultant (A)

Rogers Leonard, Louisiana State University Ag Center, Baton Rouge, LA

Tuesday, January 4, 2022

4:45 PM Managing ThryvOn - Consultant (B)

Wes Briggs, Briggs Crop Protection, Inc., Bainbridge, GA

5:00 PM Update on Herbicide-Resistant Weeds and Management Challenges in 2022

Peter A. Dotray, Texas Tech University, Texas A&M AgriLife Research and Extension Service, Lubbock, TX

Wednesday, January 5, 2022

Cotton Agronomy, Physiology & Soil Conference

COTTON AGRONOMY, PHYSIOLOGY & SOILS
WEDNESDAY EARLY MORNING

Salon A - 8:00 AM-10:00 AM

8:00 AM Cotton Response to Plant Growth Regulator Rates Under Varying Water Regimes

Avat Shekoofa, Kurt Wedegaertner and Tyson B Raper, University of Tennessee, Jackson, TN

8:15 AM Simulating Efficient Crop-Growth-Stage-Based Variable Deficit Irrigation Strategies for Sustaining Cotton Production in the Texas High Plains

Sushil Kumar Himanshu¹, **Srinivasulu Ale**², Jourdan M. Bell³, Yubing Fan², James P. Bordovsky⁴, Dennis Gitz III⁵ and David K Brauer⁶, (1)Asian Institute of Technology, Khlong Luang, Thailand, Texas A&M AgriLife Research, Vernon, TX, (2)Texas A&M AgriLife Research, Vernon, TX, (3)Texas A&M AgriLife, Amarillo, TX, (4)Texas A&M AgriLife Research Center, Lubbock, TX, (5)USDA-ARS Cropping Systems Research Laboratory, Lubbock, TX, (6)USDA-ARS, Conservation and Production Research Laboratory, Bushland, TX

8:30 AM Characterization of Heat Stress Effects on Cotton Production in the Low Deserts of Arizona

Randy Norton, University of Arizona, Safford, AZ, Blase Evancho, University of Arizona, Casa Grande, AZ, Kaleb Bryce, The University of Arizona, Safford, AZ, Joseph Thomas Best, The University of Arizona, Casa Grande, AZ and Naomi M. Pier, University of Arizona, Maricopa, AZ

8:45 AM Leaf Osmotic Potential and Morphological Traits of 40+ Cotton Varieties Growing in a Rainfall Gradient from Southwest to Central Texas

Xuejun Dong, Texas A&M AgriLife Research, Uvalde, TX and Dale A. Mott, Texas A&M AgriLife Extension Service, College Station, TX

9:00 AM The Effect of Cultivar and Growth Temperature on Root System Growth and Root Anatomy.

John L. Snider, Nuengsap Thangthong, Cristiane Pilon and Chiara Rossi, University of Georgia, Tifton, GA

9:15 AM Relationship between Boll Counts and Lint Yield

Seth A. Byrd¹, Bradley R Wilson², Cayden B. Catlin¹, Andrea J Althoff¹, Wyatt Medina¹ and Trace Holsted¹, (1)Oklahoma State University, Stillwater, OK, (2) University of Missouri, Portageville, MO

9:30 AM Second Year Results for 48-Inch Row Spacing in Cotton in South Alabama

Steve M Brown, Dalton E Barber and Samuel A Frazier, Auburn University, Auburn University, AL

COTTON AGRONOMY, PHYSIOLOGY & SOILS
WEDNESDAY EARLY MORNING
MS STUDENT COMPETITION

Salon M - 8:00 AM-10:00 AM

8:00 AM A Study Comparing Visually Mechanical Damaged Untreated Vs. Treated Cotton Seed and Its Germination Seedling Performance

Lori Unruh-Snyder, NC State, Zebulon, NC and **Matthew Starr**, NC State, Raleigh, NC

8:15 AM Impact of Planting Pattern and Planting Population on Cotton Development, Fruit Distribution, Yield, and Fiber Quality

William Joseph Rutland¹, Brian K. Pieralisi¹, Darrin M. Dodds², John Wesley Lowe², Whitney Crow³, Justin McCoy⁴, Tyler S Soignier¹, Bradley Norris² and Eli B. Hobbs², (1)Mississippi State University, Starkville, MS, (2)Mississippi State University, Mississippi State, MS, (3)Mississippi State University, Stoneville, MS, (4)Mississippi State Univ, Verona, MS

8:30 AM Evaluating Wide Row Production Systems in Georgia

Caitlyn B Lawton¹, John L. Snider¹, Phillip Roberts¹, Yangxuan Liu², Peng Chee¹ and Lavesta C. Hand¹, (1)University of Georgia, Tifton, GA, (2)Extension Economists, Department of Agricultural & Applied Economics, Tifton, GA

8:45 AM Variable Rate Seeding in Cotton

Kyle Smith¹, Michael T. Plumblee² and Kendall R. Kirk², (1)Clemson University Edisto REC, Blackville, SC, (2)Clemson University, Blackville, SC

9:00 AM Enhancing Nitrogen Use Efficiency in Alabama Cotton Production Systems

Evan Rose, Audrey V. Gamble and Anna Johnson, Auburn University, Auburn, AL

9:15 AM Physiological Contributors to Cotton Yield Loss Under Nitrogen Stress.

Amrit Pokhrel, John L. Snider, Simerjeet Virk, Ved Parkash, Henry Yabbey Sintim, Lavesta C. Hand, George Vellidis, Devendra Prasad Chalise and Joshua M. Lee, University of Georgia, Tifton, GA

9:30 AM Cover Crop Influence on Soil Health and Cotton Production in Alabama

Hannah Decker¹, Anna Johnson¹, Audrey V. Gamble¹ and Kip Balkcom², (1) Auburn University, Auburn, AL, (2)USDA, Auburn, AL

9:45 AM The Effect of Plant Growth Management on Cotton Susceptibility to Drought during the Flowering and Boll Filling Stages

Joshua M. Lee, John L. Snider, Lavesta C. Hand, Phillip Roberts, Devendra Prasad Chalise, Amrit Pokhrel, Navneet Kaur, Ved Parkash and Gurpreet Virk, University of Georgia, Tifton, GA

**COTTON AGRONOMY, PHYSIOLOGY & SOILS
WEDNESDAY LATE MORNING**

Salon A - 10:30 AM-12:00 PM

10:30 AM Nutrient Stress Effects on Cotton Productivity

Henry Yabbey Sintim, University of Georgia, Tifton, GA

10:45 AM Current Issues in Potassium Fertilization of Cotton in the Southeast

Glendon Harris, University of Georgia, Tifton, GA

11:00 AM Central and South Texas Cotton Harvest-Aid Evaluations

Benjamin M. McKnight¹, Dale A. Mott², Corrie Bowen³ and Kate Harrell-Crumley³, (1)Texas A&M University, College Station, TX, (2)Texas A&M AgriLife Extension Service, College Station, TX, (3)Texas A&M AgriLife Extension Service, Wharton, TX

11:15 AM Effects of Low Dose Defoliant Rates on Late Planted Cotton in Georgia

Lavesta C. Hand, A. Stanley Culpepper and John L. Snider, University of Georgia, Tifton, GA

11:30 AM Impact of Visual Mechanical Damage on Cotton Germination & Quality

Lori Unruh-Snyder¹, Murilo Maeda², Guy D. Collins³, Keith L. Edmisten⁴, Marisa Crisp⁵, Mika'el Chabeda⁵, Seth A. Byrd⁶, Mitchell K Williams⁷, Gaylon Morgan⁸ and Gabriel Harris⁵, (1)NC State, Zebulon, NC, (2)Texas A&M AgriLife Extension, Lubbock, TX, (3)North Carolina State University, Rocky Mount, NC, (4)North Carolina State University, Raleigh, NC, (5)NC State, Raleigh, NC, (6)Oklahoma State University, Stillwater, OK, (7)North Carolina State University, Sanford, NC, (8)Cotton Incorporated, Cary, NC

11:45 AM A Beltwide Evaluation of Cotton Seed Quality Parameters

Lori Unruh-Snyder¹, Yu Bai¹, Jeremais Endrina¹, Saara Raja¹, Murilo Maeda², Gaylon Morgan³, Steve M Brown⁴, Seth A. Byrd⁵, Kent Chapman⁶, Guy D. Collins⁷, Michael K. Dowd⁸, Keith L. Edmisten⁹, Hunter Frame¹⁰, Michael A. Jones¹¹, Benjamin M. McKnight¹², Calvin D Meeks¹³, Randy Norton¹⁴, Brian K. Pieralisi¹⁵, Tyson B Raper¹⁶, Bill Robertson¹⁷, Tyler Sandlin¹⁸, John L. Snider¹⁹ and David L. Wright²⁰, (1)NC State, Raleigh, NC, (2)Texas A&M AgriLife Extension, Lubbock, TX, (3)Cotton Incorporated, Cary, NC, (4)Auburn University, Auburn University, AL, (5)Oklahoma State University, Stillwater, OK, (6)University of North Texas, Denton, TX, (7)NC State University, Rocky Mount, NC, (8)USDA-ARS Southern Regional Research Center, New Orleans, LA, (9)North Carolina State University, Raleigh, NC, (10)Virginia Polytechnic Institute & State University, Blacksburg, VA, (11)Clemson University, Florence, SC, (12)Texas A&M University, College Station, TX, (13)University of Missouri, Portageville, MO, (14)University of Arizona, Safford, AZ, (15)Mississippi State University, Starkville, MS, (16)University of Tennessee, Jackson, TN, (17)University of Arkansas System Division of Ag, Newport, AR, (18)Auburn University, Belle Mina, AL, (19)University of Georgia, Tifton, GA, (20)University of Florida, Quincy, FL

**COTTON AGRONOMY, PHYSIOLOGY & SOILS
WEDNESDAY LATE MORNING
MS STUDENT COMPETITION**

Salon M - 10:30 AM-12:00 PM

10:30 AM Discrimination of Abiotic and Biotic Stressors in Cotton Using Remote Measurements

Morgan N Kleibrink¹, Reagan L. Noland², Benjamin M. McKnight¹ and Thomas Isakeit¹, (1)Texas A&M University, College Station, TX, (2)Texas A&M Agrilife Extension Service, San Angelo, TX

10:45 AM Modeling of Greenhouse Gas Emission from Conventional and Organic Cotton Fields

Noriki Miyanaka¹, Nithya Rajan¹, Kenneth Casey², Sk. Musfiq-Us- Salehin¹, Peter Tomlinson³ and Jaehak Jeong⁴, (1)Texas A&M University, College Station, TX, (2)Texas A&M Agrilife Research, Amarillo, TX, (3)Kansas State University, Manhattan, KS, (4)Texas A&M Blackland Research and Extension Center, Temple, TX

11:00 AM Growth Stage Specific Irrigation Scheduling and Yield Response in the Oklahoma Panhandle

Andrea J Althoff¹, Bradley R Wilson², Cayden B. Catlin¹, Jason Warren¹, Sumit Sharma³, Cameron Murley³, Randy Norton⁴ and Seth A. Byrd¹, (1)Oklahoma State University, Stillwater, OK, (2)University of Missouri, Portageville, MO, (3)Oklahoma State University, Goodwell, OK, (4)University of Arizona, Safford, AZ

11:15 AM Variety Selection: A Valuable Tool in the Management of Water Relations in Cotton Production

Kurt Wedegaertner, Avat Shekoofa, Kendall Sheldon, Sayantan Sarkar and Tyson B Raper, University of Tennessee, Jackson, TN

11:30 AM Effect of Planting Date, Seeding Rate, and Seed Size on Cotton Growth and Yield in South Carolina

Sarah K. Holladay¹, Michael T. Plumblee², Michael A. Jones¹ and Matthew D Inman¹, (1)Clemson University, Florence, SC, (2)Clemson University, Blackville, SC

11:45 AM Physiological Factors Affecting Productivity in Diverse Cotton Genotypes

Navneet Kaur¹, John L. Snider¹, Andrew Paterson², Gurpreet Virk¹ and Ved Parkash¹, (1)University of Georgia, Tifton, GA, (2)College of Agricultural and Environmental Sciences, The University of Georgia, Athens, GA

**COTTON AGRONOMY, PHYSIOLOGY & SOILS
WEDNESDAY EARLY AFTERNOON**

Salon A - 1:15 PM-3:00 PM

1:15 PM Cover Cropping History Influence on Cotton Boll Distribution, Lint Yield, and Quality

Eric D Billman and B. Todd Campbell, USDA-ARS, Florence, SC

1:30 PM Cover Crop Influence on Potassium Uptake in the Southeastern Cotton Belt

Brian K. Pieralisi¹, Darrin M. Dodds², Justin McCoy³, Angus Catchot², Eli B. Hobbs², William Joseph Rutland¹, Tyler S Soignier¹ and Bradley Norris², (1) Mississippi State University, Starkville, MS, (2)Mississippi State University, Mississippi State, MS, (3)Mississippi State Univ, Verona, MS

1:45 PM Dryland Cotton Production Using Cover Crops and Crop Rotations on the Texas High Plains

C.D. Ray White, Texas A&M AgriLife Research, Lubbock, TX, Katie L. Lewis, Texas A&M AgriLife Research and Extension Center, Lubbock, TX and J. Wayne Keeling, Texas A&M AgriLife Research Center, Lubbock, TX

2:00 PM Effects of Cotton Stalk Management and Cover Crop Use on Soil Properties and Cotton Leafroll Dwarf Virus Incidence

Samuel A Frazier¹, Steve M Brown¹, Kip Balkcom², Alana Lynn Jacobson³ and Dalton E Barber¹, (1)Auburn University, Auburn University, AL, (2) USDA, Auburn, AL, (3)Auburn University, Auburn, AL

2:15 PM Assessing the Impacts of Cover Crop Termination Dates on Cotton Yield in the Texas Rolling Plains

Jasdeep Singh¹, Srinivasulu Ale¹, Paul DeLaune¹ and Edward M. Barnes², (1) Texas A&M AgriLife Research, Vernon, TX, (2)Cotton Incorporated, Cary, NC

2:30 PM Summary of Cotton Production Under Three Long-Term Cover Crop Systems in the Texas Rolling Plains

Paul DeLaune¹, Katie L. Lewis², Srinivasulu Ale¹ and Emi Kimura³, (1)Texas A&M AgriLife Research, Vernon, TX, (2)Texas A&M AgriLife Research and Extension Center, Lubbock, TX, (3)Texas A&M AgriLife Research and Extension Service, Vernon, TX

**COTTON AGRONOMY, PHYSIOLOGY & SOILS
WEDNESDAY EARLY AFTERNOON
PHD STUDENT COMPETITION**

Salon M - 1:00 PM-3:15 PM

1:00 PM Cotton Plant Nitrogen Availability Prediction Using Active Crop Canopy Sensors as Input on Machine Learning Algorithms

Leticia Bernabe Santos¹, Francielle Morelli Ferreira¹, Murilo Santana Martins¹, Fagner Augusto Rontani¹, Franciele Morlin Carneiro¹, Ziany Neiva Brandao² and Luciano Shozo Shiratsuchi¹, (1)Louisiana State University AgCenter, Baton Rouge, LA, (2)Embrapa Cotton, Brasilia, Brazil

1:15 PM Effect of Nitrogen Deficiency on Physiological Processes in Cotton

Ved Parkash, John L. Snider, Amrit Pokhrel, Gurpreet Virk, Henry Yabbey Sintim, Lavesta C. Hand and Cristiane Pilon, University of Georgia, Tifton, GA

1:30 PM Phosphorus and Potassium Effects on Cotton Lint Yield and Fiber Quality

Amee Bumguardner, Texas Tech University, Lubbock, TX and Katie L. Lewis, Texas A&M AgriLife Research and Extension Center, Lubbock, TX

1:45 PM White Clover Living Mulch Impacts on Soil Health in Cotton Production Systems of Georgia

Chandler E Gruener, Matthew R Levi, Nicholas T Basinger, Nick S Hill and Nandita Gaur, University of Georgia, Athens, GA

2:00 PM Benefits and Consequences of No-Tillage and Cover Crop Use in Texas Semi-Arid Cotton Production

Joseph Alan Burke, Texas A&M AgriLife Research, Lubbock, TX, Katie L. Lewis, Texas A&M AgriLife Research and Extension Center, Lubbock, TX, Paul DeLaune, Texas A&M AgriLife Research, Vernon, TX, Jamie Foster, Texas A&M AgriLife Research, Corpus Christi, TX and J. Wayne Keeling, Texas A&M AgriLife Research Center, Lubbock, TX

2:15 PM The Effects of Long Term Storage on Upland Cotton Seed Germination

Mitchell K Williams¹, Guy D. Collins², Keith L. Edmisten³, Lori Unruh Snyder³ and Emily H Griffith³, (1)North Carolina State University, Sanford, NC, (2)North Carolina State University, Rocky Mount, NC, (3)North Carolina State University, Raleigh, NC

2:30 PM Use of Reviton as a Cotton Harvest Aid

Lou Adams¹, Tom Barber², Jason K Norsworthy¹, Tyson B Raper³, Donnie Miller⁴, Brian K. Pieralisi⁵ and Ryan Doherty⁶, (1)University of Arkansas, Fayetteville, AR, (2)University of Arkansas-Extension, Lonoke, AR, (3)University of Tennessee, Jackson, TN, (4)LSU AgCenter, St. Joseph, LA, (5)Mississippi State University, Starkville, MS, (6)University of Arkansas Monticello, Monticello, AR

2:45 PM Cotton Tolerance to Potassium Borate: A Nutritional and Dicamba Volatility Reducing Agent

Mason Castner¹, Jason K Norsworthy¹, Samuel Noe¹ and Tom Barber², (1) University of Arkansas, Fayetteville, AR, (2)University of Arkansas-Extension, Lonoke, AR

3:00 PM Yield Partitioning Effects of Low-Rate Auxin Applications on Sensitive Cotton

Savana D Denton¹, Tyson B Raper¹, Darrin M. Dodds² and Christopher Main³, (1)University of Tennessee, Jackson, TN, (2)Mississippi State University, Mississippi State, MS, (3)Dow AgroSciences, Medina, TN

COTTON AGRONOMY, PHYSIOLOGY & SOILS - WEDNESDAY LATE AFTERNOON - PHD STUDENT COMPETITION

Salon M - 3:30 PM-5:00 PM

3:30 PM Impact of Extreme Temperatures on Growth and Photosynthetic Performance of Advanced Cotton Genotypes

Gurpreet Virk, John L. Snider, Peng Chee, Navneet Kaur and Alessandro Ermanis, University of Georgia, Tifton, GA

3:45 PM Evaluation of Drain Tile Performance in Cotton

Tyler S Soignier¹, Brian K. Pieralisi¹, Darrin M. Dodds², Jason Krutz³, William Joseph Rutland¹, Bradley Norris² and Eli B. Hobbs², (1)Mississippi State University, Starkville, MS, (2)Mississippi State University, Mississippi State, MS, (3)Mississippi State University, Stoneville, MS

4:00 PM Integration of Unmanned Aerial Systems Images and DSSAT Modeling in Predicting Cotton Growth and Yield

Haibin Gu, Department of Plant and Soil Science, Texas Tech University, Lubbock, TX and Wenxuan Guo, Texas A&M AgriLife Research and Extension Center, Lubbock, TX, Department of Plant and Soil Science, Texas Tech University, Lubbock, TX

4:15 PM Effects of Spatial and Temporal Scales on Assessing Cotton Water Stress Using Unmanned Aerial System Images

Oluwatola I Adedeji, Texas Tech University, Lubbock, TX, Zhe Lin, Department of Plant & Soil Science, Texas Tech University, Lubbock, TX and Wenxuan Guo, Department of Plant and Soil Science, Texas Tech University, Lubbock, TX

4:30 PM Evaluation of Spatio-Temporal Variability of Soil and Cotton Using Traditional Soil Analysis, Remote Sensing, and Machine Learning Techniques

Getulio de Freitas Seben Junior¹, Franciele Morlin Carneiro², Francielle Morelli Ferreira³, Leticia Bernabe Santos², Murilo Santana Martins², Fagner Augusto Rontani², Paulo Eduardo Teodoro⁴, Carlos Antonio da Silva Junior⁵ and Luciano Shozo Shiratsuchi², (1)State University of Mato Grosso (UNEMAT), Nova Mutum, Brazil, Louisiana State University, Baton Rouge, LA, (2)Louisiana State University AgCenter, Baton Rouge, LA, (3)Louisiana State University AgCenter, Baton Rouge, LA, State University of Mato Grosso (UNEMAT), Nova Mutum, Brazil, Sao Paulo State University (UNESP), Jaboticabal, Brazil, (4)Federal University of Mato Grosso do Sul, Chapadao do Sul, Brazil, (5)State University of Mato Grosso (UNEMAT), Sinop, Brazil

4:45 PM Machine Learning Techniques to Predict Cotton Yield Using Satellite Remote Sensing

Francielle Morelli Ferreira¹, Nayane Jaqueline Costa Maia², Elizabeth Haruna Kazama², Getulio de Freitas Seben Junior³, Danilo Tedesco², Phillip Lanza⁴, Ziany Neiva Brandao⁵, Glauco de Souza Rolim², Rouverson Pereira da Silva² and Luciano Shozo Shiratsuchi⁴, (1)Louisiana State University AgCenter, Baton Rouge, LA, State University of Mato Grosso (UNEMAT), Nova Mutum, Brazil, Sao Paulo State University (UNESP), Jaboticabal, Brazil, (2)Sao Paulo State University (UNESP), Jaboticabal, Brazil, (3)State University of Mato Grosso (UNEMAT), Nova Mutum, Brazil, (4)Louisiana State University AgCenter, Baton Rouge, LA, (5)Embrapa Cotton, Brasilia, Brazil

**COTTON AGRONOMY, PHYSIOLOGY & SOILS
WEDNESDAY LATE AFTERNOON**

Salon A - 4:00 PM-5:00 PM

4:00 PM UAS-Based Platform for Evaluating the Performance of Cotton Cultivars for Research and Outreach.

Juan Landivar¹, Mahendra Bhandari¹, Josh McGinty², Murilo Maeda³, Jose Landivar Landivar-Scott¹, Anjin Chang⁴ and Daniel Gonzales⁵, (1)Texas A&M AgriLife Research, Corpus Christi, TX, (2)Texas A&M AgriLife Extension Service, Corpus Christi, TX, (3)Texas A&M AgriLife Extension, Lubbock, TX, (4)Texas A&M University - Corpus Christi, Corpus Christi, TX, (5)Texas A&M AgriLife, Corpus Christi, TX

4:15 PM Cotton Open Boll Counting Using UAS Imagery and Deep Learning

Zhe Lin, Department of Plant & Soil Science, Texas Tech University, Lubbock, TX and Wenxuan Guo, Department of Plant and Soil Science, Texas Tech University, Lubbock, TX

4:30 PM Commercial-Scale Demonstration of Detection, 3-Dimensional Visualization and Mitigation of Soil Compaction for Cotton Using AI-Informed, Multimodal, Air-Launched Sensors That Enable Prescription-Driven, Variable Depth Tillage

John R. Anderson Jr., **G. Hunt Bowers**, Jacob S. Lasky, Clayton R. Honeycutt and Lars Dyrud, EarthOptics, Arlington, VA

COTTON AGRONOMY & PHYSIOLOGY BUSINESS MEETING

Salon A - 5:15 PM-7:00 PM

Cotton Consultants Conference

**CONSULTANTS CONFERENCE GENERAL SESSION
WEDNESDAY MORNING**

Salon G - 8:00 AM-12:00 PM

8:00 AM A Severe Begomovirus-Satellite DNA Disease Complex in Texas Lower Rio Grande Okra Fields and Its Potential Threat to Cotton Production

Olufemi Alabi, Dept of PI Pathol & Microbiol, Weslaco, TX

8:10 AM CLRDV Overview and Update

Steve M Brown, Auburn University, Auburn University, AL

8:20 AM Regulatory Update

Don Parker, National Cotton Council, Cordova, TN

8:40 AM Cotton Maturities and Management Across the Belt

Tyson B Raper, University of Tennessee, Jackson, TN

9:00 AM Mepiquat Use in The Modern Era - A MetaAnalysis from 2011-2021

Jay Mahaffey, Bayer Crop Science, Scott, MS

9:20 AM Farm Labor Shortages: Experience, Liability and Policy (H2A)

Robbie Minnich, National Cotton Council, Washington, DC and Jarrod Sharp, Federation of Employers and Workers of American (FEWA), Bay City, TX

9:40 AM Spray Droplets and Spacial Buffers

Jeff Gore, Mississippi State University, Stoneville, MS

10:00 AM Break

10:30 AM Bayer - Deltapine Class of 22 varieties

Eric Best, Bayer Crop Science, Lubbock, TX

10:50 AM PhytoGen Varieties

Joel C Faircloth, PhytoGen Seed Company, LLC, Clemmons, NC

11:10 AM New Variety Offerings from BASF

Will Groover, BASF Corporation, Guyton, GA

11:30 AM 2022 NexGen Varieties

Douglas J. Jost, Americot, Garden City, TX

Cotton Disease Council

COTTON DISEASE COUNCIL STUDENT PAPER COMPETITION

Conf. Room 16-17 - 1:00 PM-3:15 PM

1:00 PM Deep Surveillance of Cotton Infecting Begomoviruses in Pakistan Using Targeted Enrichment High-Throughput Sequencing

Cory Von Keith¹, Javed Iqbal¹, Cecilia Villegas², Olufemi Alabi³ and Judith K Brown¹, (1)University of Arizona, Tucson, AZ, (2)Texas A&M University, Weslaco, TX, (3)Dept of PI Pathol & Microbiol, Weslaco, TX

1:15 PM Performance of Root-Knot and Reniform Nematode Resistant Cotton Cultivars in Alabama

Ashton Kate Turner¹, Kathy Lawrence¹ and John Richburg², (1)Auburn University, Auburn, AL, (2)Corteva Agriscience, Headland, AL

1:30 PM Genomic Plasticity of Fusarium Oxysporum f. Sp. Vasinfectum from Cotton Fields

Catherine Danmaigona Clement¹, Zunyong Liu¹, Eun-Gyu No¹, Lin Zhang¹, Steve Hague¹, Terry Wheeler², Ping He¹, Jane K Dever³ and Libo Shan¹, (1) Texas A&M University, College Station, TX, (2)Texas A&M AgriLife Research, Lubbock, TX, (3)Texas A&M AgriLife Research and Extension Center, Lubbock, TX

1:45 PM Temporal Dynamics of Fusarium Oxysporum f. Sp. Vasinfectum Race 4 in Field and Growth Chamber Trials

Roy Davis and Thomas M. Chappell, Texas A&M University, College Station, TX

2:00 PM FOV4 Soil Inoculum Quantification in Response to Resistant and Susceptible Cotton Cultivars

Jennifer Chagoya¹, Mauricio Ulloa², Terry A. Wheeler¹, Heather Arce³, Joel Arce¹ and Cecilia Monclova-Santana⁴, (1)Texas A&M AgriLife Research, Lubbock, TX, (2)USDA-ARS, PA, CSRL, Plant Stress and Germplasm Development Research, Lubbock, TX, (3)Texas A&M AgriLife Research, El Paso, TX, (4)Texas A&M AgriLife Extension, Lubbock, TX

2:15 PM Fungicide Sensitivity of Cercospora Sojina to Demethylation Inhibitors and Methyl Benzimidazole Carbamates

Elias Zuchelli¹, Heather M Kelly¹ and Claire Zuchelli², (1)University of Tennessee, Jackson, TN, (2)The University of Tennessee, Jackson, TN

2:30 PM Evaluating the Impact of Bt and Non-Bt Corn Hybrids on Aflatoxin and Fumonisin Levels in Tennessee

Autumn A. McLaughlin, Heather M Kelly and Scott D. Stewart, University of Tennessee, Jackson, TN

Wednesday, January 5, 2022

2:45 PM Cover Crop Implications on Plant Parasitic Nematode Populations

Shelly Neill Pate¹, Heather M Kelly¹ and Lesley A Schumacher², (1)University of Tennessee, Jackson, TN, (2)USDA, Jackson, TN

**COTTON DISEASE COUNCIL
WEDNESDAY LATE AFTERNOON**

Conf. Room 16-17 - 4:00 PM-5:00 PM

4:00 PM Relative Performance of Reniform Nematode Resistant Cotton Varieties, Aglogic 15G and Telone II for the Management of Yield Losses Due to Reniform Nematodes in Large Scale Field Plots

Saleh M. Ahmed, Jemila Chellappa, Michael T. Plumblee and John Mueller, Clemson University, Blackville, SC

4:15 PM Beltwide Nematode Research and Education Committee: Cultivar and Nematicide Responses in Nematode Soils, 2021

Travis R. Faske, University of Arkansas Division of Agriculture, Lonoke, AR, Thomas W. Allen, Mississippi State University, Delta Research and Extension Center, Stoneville, MS, Zane J. Grabau, University of Florida, Gainesville, FL, Jiahuai Hu, University of Arizona, Tucson, AZ, Robert Kemerait, University of Georgia, Tifton, GA, Heather M Kelly, University of Tennessee, Jackson, TN, David B. Langston, Virginia Tech, Suffolk, VA, Kathy S Lawrence, Auburn University, Auburn University, AL, John Mueller, Clemson University, Blackville, SC, Paul Price, LSU AgCenter, Winnsboro, LA, Tristan Watson, LSU AgCenter, Baton Rouge, LA, Terry A. Wheeler, Texas A&M AgriLife Research, Lubbock, TX and Tessie H. Wilkerson, Mississippi State University-Delta Research and Extension Center, Stoneville, MS

4:30 PM Assessment of Cotton Varieties with Resistance to Root-Knot and Reniform Nematodes in Fields Infested with Meloidogyne Incognita

Robert Kemerait, University of Georgia, Tifton, GA and Jeremy M. Kichler, University of Georgia Cooperative Extension, Moultrie, GA

4:45 PM Influence of Cotton Host Resistance and Winter Cover Crops on Reniform Nematode Population Dynamics and Estimated Lint Yield

Tristan Watson, LSU AgCenter, Baton Rouge, LA

COTTON DISEASE COUNCIL BUSINESS MEETING

Conf. Room 16-17 - 5:00 PM-7:00 PM

Cotton Economics and Marketing Conference

COTTON ECONOMIC OUTLOOK SYMPOSIUM

Salon F - 10:30 AM-12:00 PM

10:30 AM Cotton Marketer of the Year Award

O. A. Cleveland, Mississippi State University, Mississippi State, MS

10:40 AM Cotton Policy Updates

Bart L. Fischer, Texas A & M University, College Station, TX

11:00 AM Logistics and the Cotton Market

Buddy Allen, ACSA, Memphis, TN

11:20 AM Cotton Market Outlook

O. A. Cleveland, Mississippi State University, Mississippi State, MS and Jarral T. Neeper, Trucott, LLC, Bakersfield, CA

**COTTON ECONOMICS AND MARKETING
WEDNESDAY EARLY AFTERNOON**

Salon F - 1:30 PM-3:30 PM

1:30 PM Evaluating Best Management Practices Using Computer Simulated Farm-Scale Cotton Experiments

Rachel Judd¹, Yangxuan Liu², Ritesh Karki³, Amanda R Smith², Latif Kalin³, Unmesh Koirala⁴ and Damian Adams⁴, (1)University of Georgia, Athens, GA, (2)Extension Economists, Department of Agricultural & Applied Economics, Tifton, GA, (3)Auburn University, Auburn, AL, (4)University of Florida, Gainesville, FL

1:45 PM Evaluating Economic Outcomes of the Utilization of Cover Crops in Southeastern Cotton Production

Madison G Harkins¹, Yangxuan Liu², Alejandro Plastina³, Guy Hancock⁴ and Amanda R Smith², (1)University of Georgia, Tifton, GA, (2)Extension Economists, Department of Agricultural & Applied Economics, Tifton, GA, (3)Iowa State University, Ames, IA, (4)University of Georgia, Athens, GA

2:00 PM Assessing Grower Willingness to Accept for Incentives in Sustainability Program Participation

Grace E Blackwell and Donna M McCallister, Texas Tech University, Lubbock, TX

2:15 PM Estimating Yield and Revenue Potential from Autonomous Robotics: Linear Programming Application Applied to Harvest Systems

Terry W Griffin, Kansas State University, Manhattan, KS

2:30 PM Forecasting Cottonseed Prices

Jeffrey Richard Wright and John R.C. Robinson, Texas A&M University, College Station, TX

2:45 PM Risk Efficiency of Alternative Pre-Harvest Marketing Strategies for South Texas Cotton

Shahin Bahrami and John R.C. Robinson, Texas A&M University, College Station, TX

3:00 PM A Gravity Model Analysis and Its Implications on Chinese Apparel Export Flows

Bing Liu¹, Darren Hudson¹ and Jon Devine², (1)Texas Tech University, Lubbock, TX, (2)Cotton Incorporated, Cary, NC

3:15 PM Estimating Chinese Cotton End-Use

Jon Devine, Cotton Incorporated, Cary, NC

COTTON ECONOMICS AND MARKETING POSTERS

Salon F - 1:30 PM-5:00 PM

1. Economics of Dryland Cropping Systems in the Texas High Plains

Will Keeling, Texas A&M AgriLife Extension, Lubbock, TX, Katie L. Lewis, Texas A&M AgriLife Research and Extension Center, Lubbock, TX and C.D. Ray White, Texas A&M AgriLife Research, Lubbock, TX

2. Analysis of Net Present Value of Lime Application in Cotton

Raedan L Sharry and Brian Arnall, Oklahoma State University, Stillwater, OK

3. Estimating the Economic Benefit of Corn Refuges within Cotton Production Systems

Michael A. Deliberto and Brian Hilbun, LSU AgCenter, Baton Rouge, LA

4. Spatial Analysis of Crop Insurance Indemnities Paid to Cotton Producers at the County Level from 1989 to 2021

Aaron Smith and **Jordan Peterson**, University of Tennessee, Knoxville, TN

Cotton Engineering-Systems Conference

COTTON ENGINEERING-SYSTEMS
WEDNESDAY EARLY AFTERNOON

Conf. Room 13 - 1:00 PM-3:30 PM

1:00 PM Design and Performance Testing of a Robotic Cotton Harvesting End-Effector

Hussein Gharakhani and J. Alex Thomasson, Mississippi State University, Starkville, MS

1:15 PM On-Farm Evaluation of the Potential of Rank Growth as Influenced by Seeding Rate and Soil Type in Georgia

Mathew Tucker¹, Simerjeet Virk¹, Jeremy M Kichler², Curt Majeski³ and Lavesta C. Hand¹, (1)University of Georgia, Tifton, GA, (2)UGA Cooperative Extension, Moultrie, GA, (3)JCM Crop Consulting, Leesburg, GA

1:30 PM Exploring Cotton Bale Fiber Quality Variability within Round Modules Employing John Deere's HID System

Luke M Fuhrer¹, Wesley M Porter¹, Jianing He¹ and Edward M. Barnes², (1) University of Georgia, Tifton, GA, (2)Cotton Incorporated, Cary, NC

1:45 PM Site-Specific Treatment of Late-Season Weed Escapes in Cotton Using an RTK-GPS Guided Remotely Piloted Aerial Application System

Ubaldo Torres¹, Dan E Martin², Bishwa Sapkota¹, Bholum Gurjar¹, Matthew Kutugata¹ and Muthukumar V Bagavathiannan¹, (1)Texas A&M University, College Station, TX, (2)USDA-ARS, College Station, TX

2:00 PM Real-Time Weed Detection and Removal Using Deep Learning and Laser

Canicius Mwitta and Glen C. Rains, University of Georgia, Tifton, GA

2:15 PM Developing a UAV Sourced Database for AI Trash Detection in Cotton Fields

Cody D. Blake, Sean Donohoe and Joe W. Thomas, USDA ARS, Stoneville, MS

2:30 PM In-Field Cotton Yield and Loan Rate Prediction Using Machine Learning Regression Algorithms

Jianing He¹, Wesley M Porter¹, Luke Fuhrer¹, Joe W. Thomas² and Christopher D. Delhom³, (1)University of Georgia, Tifton, GA, (2)USDA ARS, Stoneville, MS, (3)USDA-ARS Southern Regional Research Center, New Orleans, LA

2:45 PM Fiber Quality Mapping for Yield and Quality Interaction

Jason K. Ward, North Carolina State University, Raleigh, NC, Lucas Mitchell, NC State University, Raleigh, NC and Edward M. Barnes, Cotton Incorporated, Cary, NC

3:00 PM A National Evaluation of the John Deere Onboard Module Weighing System

Wesley M Porter¹, Edward M. Barnes², Seth A. Byrd³, Guy D. Collins⁴, Keith L. Edmisten⁵, Jeremy M. Kichler⁶, Gaylon Morgan², Randy Norton⁷ and Brian K. Pieralisi⁸, (1)University of Georgia, Tifton, GA, (2)Cotton Incorporated, Cary, NC, (3)Oklahoma State University, Stillwater, OK, (4)North Carolina State University, Rocky Mount, NC, (5)North Carolina State University, Raleigh, NC, (6)University of Georgia Cooperative Extension, Moultrie, GA, (7)University of Arizona, Safford, AZ, (8)Mississippi State University, Starkville, MS

3:15 PM On-Farm Cotton Fiber Quality Mapping Using Radio-Frequency Identification

Francielle Morelli Ferreira¹, Evandro Bortolussi², Getulio de Freitas Seben Junior³, Leticia Bernabe Santos⁴, Franciele Morlin Carneiro⁴, Ziany Neiva Brandao⁵, Rouverson Pereira da Silva⁶ and Luciano Shozo Shiratsuchi⁴, (1) Louisiana State University AgCenter, Baton Rouge, LA, State University of Mato Grosso (UNEMAT), Nova Mutum, Brazil, Sao Paulo State University (UNESP), Jaboticabal, Brazil, (2)GMS Agribusiness, Lucas do Rio Verde, Brazil, (3)State University of Mato Grosso (UNEMAT), Nova Mutum, Brazil, (4)Louisiana State University AgCenter, Baton Rouge, LA, (5)Embrapa Cotton, Brasilia, Brazil, (6)Sao Paulo State University (UNESP), Jaboticabal, Brazil

**COTTON ENGINEERING-SYSTEMS
WEDNESDAY LATE AFTERNOON**

Conf. Room 13 - 4:00 PM-5:30 PM

4:00 PM Effects of Technology-Driven Site-Specific Irrigation Management on Cotton Yield and Water Productivity

Kelly R. Thorp¹, Daa Elshikha¹, Duke Pauli² and Alison L Thompson³, (1) USDA-ARS, Maricopa, AZ, (2)University of Arizona, Tucson, AZ, (3)USDA-ARS-ALARC, Maricopa, AZ

4:15 PM Cotton Irrigation Scheduling: Which Method Is a Best Fit? a Continued Study

Wesley M Porter¹, Calvin Perry² and John L. Snider¹, (1)University of Georgia, Tifton, GA, (2)Superintendent, Stripling Irrigation Research Park, University of Georgia, Camilla, GA

4:30 PM Data Driven Approach to Delineate Cotton Crop Management Zones

Mahendra Bhandari¹, Juan Landivar¹, Daniel Gonzalez², Anjin Chang³ and Jose Landivar Landivar-Scott¹, (1)Texas A&M AgriLife Research, Corpus Christi, TX, (2)Texas A&M Agrilife Research and Extension Center, Corpus Christi, TX, (3)Texas A&M University - Corpus Christi, Corpus Christi, TX

4:45 PM Effect of Hooded Sprayer and Spray Quality on Herbicide Particle Drift in Cotton

Simerjeet Virk, Madan Sapkota, Michael Goodnight, A. Stanley Culpepper and Lavesta C. Hand, University of Georgia, Tifton, GA

5:00 PM An Image Processing and Machine Learning-Based Method for Counting Cotton Bolls from UAV Imagery

Arun Bawa¹, Sayantan Samanta², Sushil Kumar Himanshu³, JungJin Kim⁴, Jasdeep Singh³, Srinivasulu Ale³, Anjin Chang⁵, Jinha Jung⁶, James P. Bordovsky⁷ and Edward M. Barnes⁸, (1)Texas A&M Agrilife, Vernon, TX, (2) Texas A&M University, College Station, TX, (3)Texas A&M AgriLife Research, Vernon, TX, (4)Seoul National University of Science and Technology, Seoul, Korea, Republic of (South), (5)Texas A&M University - Corpus Christi, Corpus Christi, TX, (6)Purdue University, West Lafayette, IN, (7)Texas A&M AgriLife Research Center, Lubbock, TX, (8)Cotton Incorporated, Cary, NC

5:15 PM Satellite Data Based Cotton Yield Estimation Using Deep Learning Approach

Jinha Jung¹, Akash Ashapure¹ and Juan Landivar², (1)Purdue University, West Lafayette, IN, (2)Texas A&M AgriLife Research, Corpus Christi, TX

Cotton Ginning Conference

COTTON GINNING
WEDNESDAY EARLY AFTERNOON

Salon K - 1:30 PM-3:15 PM

1:30 PM 2021 Crop Quality Update

Robbie L Seals, USDA, AMS Cotton and Tobacco Program, Memphis, TN

1:50 PM Comparing Dryland Cotton Upland Fiber Quality from On-Board Spindle and Stripper Harvesting Systems

Marinus H.J van der Sluijs, Textile Technical Services, Geelong, VIC, Australia

2:10 PM Cotton Seed Electronic Monitoring

Michael Prachar, Tri-States Grain Conditioning, Spirit Lake, IA

2:30 PM Tama Pro- Active Actions to Minimize Cotton Contamination

James Cundiff, TAMA USA, Dubuque, IA

2:50 PM Saw Thickness Impact on Ginning Energy

Paul A. Funk¹, Joe W. Thomas², Kathleen M. Yeater³, Carlos B. Armijo¹, Derek P. Whitelock¹, John D. Wanjura⁴ and Christopher D. Delhom⁵, (1)USDA-ARS Southwestern Cotton Ginning Research Laboratory, Mesilla Park, NM, (2) USDA ARS, Stoneville, MS, (3)USDA-ARS, Fort Collins, CO, (4)USDA-ARS Cotton Production and Processing Research Unit, Lubbock, TX, (5)USDA-ARS, New Orleans, LA

COTTON GINNING
WEDNESDAY LATE AFTERNOON

Salon K - 3:45 PM-5:05 PM

3:45 PM Updates to Asabe X615.2 Cotton Module Cover Material Performance

John D. Wanjura¹, Mary Ankeny², Vikki B. Martin², Edward M. Barnes², Suzanne Holmes², Matt Farrell², Christopher D. Delhom³, Harrison Ashley⁴, Gregory A. Holt¹ and Mathew G. Pelletier¹, (1)USDA-ARS Cotton Production and Processing Research Unit, Lubbock, TX, (2)Cotton Incorporated, Cary, NC, (3)USDA-ARS Southern Regional Research Center, New Orleans, LA, (4) National Cotton Council, Cordova, TN

4:05 PM Improving the Performance of a Cotton Gin Plastic Contamination Cleaner

Derek P. Whitelock¹, Paul A. Funk¹, Carlos B. Armijo¹, Neha Kothari² and Vikki B. Martin², (1)USDA-ARS Southwestern Cotton Ginning Research Laboratory, Mesilla Park, NM, (2)Cotton Incorporated, Cary, NC

4:25 PM Black Plastic Classifier Development for Plastic Inspection and Detection System on Gin Stand Feeder

Mathew G. Pelletier, Gregory A. Holt and John D. Wanjura, USDA-ARS Cotton Production and Processing Research Unit, Lubbock, TX

4:45 PM Product Updates from Lummus Ag Technology - 2022

Ross D. Rutherford and David L. Arthur, Lummus Ag Technology, Lubbock, TX

Cotton Improvement Conference

JOINT SESSION: IMPROVEMENT, DISEASE AND INSECT CONFERENCES

Salon I - 8:00 AM-12:30 PM

8:00 AM Impact of Aphid Insecticide Timing on Cotton Yield and Cotton Leaf Roll Dwarf Virus

Phillip Roberts and Sudeep Bag, University of Georgia, Tifton, GA

8:20 AM Monitoring the Seasonal Occurrence of Cotton Leafroll Dwarf Virus Spread in Relation to Aphid Vector Flights in Alabama

Jessica B Mahas, John W. Mahas, Charles Ray, Adam Kesheimer, Kassie Conner and Alana Lynn Jacobson, Auburn University, Auburn, AL

8:40 AM Evaluation Methods, Germplasm Evaluation, Genetics, and Breeding for Resistance to Fusarium Wilt Race 4 in Cotton: Personal Knowledge and Experiences

Jinfa Zhang¹, Yi Zhu¹, Abdelraheem Abdelraheem¹, Heather Arce², Jane K Dever³, Terry A. Wheeler⁴, Kater Hake⁵ and Tom Wedegaertner⁵, (1)New Mexico State University, Las Cruces, NM, (2)Texas A&M AgriLife Research, El Paso, TX, (3)Texas A&M AgriLife Research and Extension Center, Lubbock, TX, (4) Texas A&M AgriLife Research, Lubbock, TX, (5)Cotton Incorporated, Cary, NC

9:00 AM A Rapid Screening Method for Resistance to Fusarium Wilt in Cotton Caused by Fusarium Oxysporum f. Sp. Vasinfectum Race 4

Yi Zhu¹, Kathleen Willey², Terry A. Wheeler³, Jane K Dever⁴, Tom Wedegaertner⁵, Kater Hake⁵ and Jinfa Zhang¹, (1)New Mexico State University, Las Cruces, NM, (2)New Mexico Department of Agriculture, Las Cruces, NM, (3) Texas A&M AgriLife Research, Lubbock, TX, (4)Texas A&M AgriLife Research and Extension Center, Lubbock, TX, (5)Cotton Incorporated, Cary, NC

9:20 AM Resistance Gene Candidates for Fov4 Resistance in Upland Cotton

Catherine Danmaigona Clement¹, Eun-Gyu No¹, Steve Hague¹, Zunyong Liu¹, Terry Wheeler², Ping He¹, Jane K Dever³ and Libo Shan¹, (1)Texas A&M University, College Station, TX, (2)Texas A&M AgriLife Research, Lubbock, TX, (3)Texas A&M AgriLife Research and Extension Center, Lubbock, TX

9:40 AM Effective Screening for FOV4 Resistance

Don C Jones¹, Jim Olvey², Mike Olvey², Christopher Saski³ and Stephen Parris³, (1)Cotton Incorporated, Cary, NC, (2)O&A Enterprises, Maricopa, AZ, (3)Clemson University, Clemson, SC

10:00 AM Break

10:30 AM The Use of Surface Interpolation to Reduce Error in Field-Collected Genomic Datasets

Stephen Parris¹, Christopher Saski¹, Don C Jones², Jim Olvey³ and Mike Olvey³, (1)Clemson University, Clemson, SC, (2)Cotton Incorporated, Cary, NC, (3)O&A Enterprises, Maricopa, AZ

10:50 AM Transcriptomic Analysis of a Resistance Response to FOV4 in Pima Cotton

Stephen Parris¹, Christopher Saski¹, Don C Jones², Jim Olvey³ and Mike Olvey³, (1)Clemson University, Clemson, SC, (2)Cotton Incorporated, Cary, NC, (3)O&A Enterprises, Maricopa, AZ

11:10 AM Genetic Mapping of FOV4 Resistance in 3 Biparental Families

Stephen Parris¹, Jim Olvey², Mike Olvey², Don C Jones³ and **Christopher Saski**¹, (1)Clemson University, Clemson, SC, (2)O&A Enterprises, Maricopa, AZ, (3)Cotton Incorporated, Cary, NC

11:30 AM Fusarium Race 4 (FOV-4) Tolerance in Bayer Upland Cotton Germplasm Elite Lines and Commercial Varieties

David W Albers, Bayer Crop Science, St. Louis, MO, Mercy Kabahuma, Bayer, St. Louis, MO, Kolbyn Joy, Bayer, Lubbock, TX and Mike Olvey, O&A Enterprises, Maricopa, AZ

11:50 AM Release of Fusarium Race 4 Resistant Cotton Strains

Mike Olvey¹, Jim Olvey¹, Don C Jones², Christopher Saski³ and Stephen Parris³, (1)O&A Enterprises, Maricopa, AZ, (2)Cotton Incorporated, Cary, NC, (3)Clemson University, Clemson, SC

12:10 PM Threats of Climate Change and Genetic Potential of Pakistani Cottons for Development of Climate Resilient Accessions

Sajid Majeed¹, Iqar Ahmad Rana¹, Rana Muhammad Atif¹, Xiongming Du² and **Muhammad Tehseen Azhar**³, (1)University of Agriculture, Faisalabad, Pakistan, (2)Institute of Cotton Research of Chinese Academy of Agricultural Sciences (ICR, CAAS), Anyang, China, (3)Bahauddin Zakariya University, Multan, Pakistan

**COTTON IMPROVEMENT
WEDNESDAY EARLY AFTERNOON**

Salon I - 1:15 PM-3:15 PM

1:15 PM Fiber Quality Characterization of Chromosome Substitution Lines

Christian Hitzelberger, Texas A&M University, College Station, TX, Robert Vaughn, Texas A&M AgriLife Research, College Station, TX and David M. Stelly, Texas A&M University System, College Station, TX

1:35 PM Identity-By-Descent-Based GWAS Identifies Novel QTL for Fiber Quality Traits in a MAGIC Population

David D. Fang¹, Maojun Wang¹, Gregory N. Thyssen¹, Johnie N. Jenkins² and Jack C. McCarty², (1)Cotton Fiber Bioscience Research Unit, USDA-ARS-SRRC, New Orleans, LA, (2)USDA-ARS, Mississippi State, MS

1:55 PM Fiber Properties for Vortex Spinning Upland Cotton

Wayne Smith¹, Eric F. Hequet² and Steve Hague¹, (1)Texas A&M University, College Station, TX, (2)Texas Tech University, Lubbock, TX

2:15 PM Characterizations of a Maturity Distributional Parameter Evaluating Immature Fiber Contents within and Among Cotton Samples

Hee Jin Kim, USDA-ARS, Southern Regional Research Center, New Orleans, LA, Christopher D. Delhom, USDA-ARS Southern Regional Research Center, New Orleans, LA, Yongliang Liu, USDA-ARS, SRRC, New Orleans, LA, Don C Jones, Cotton Incorporated, Cary, NC and Bugao Xu, University of North Texas, Denton, TX

2:35 PM Breeding *Gossypium hirsutum* for Improved Verticillium Dahliae Resistance with an Elite Fiber Quality Profile

Reagan B Heinrich, Texas Tech University, Lubbock, TX, Jane K Dever, Texas A&M AgriLife Research and Extension Center, Lubbock, TX and Brendan Kelly, Texas A&M Agrilife Research, Lubbock, TX

2:55 PM Seed-Score: A Method to Characterize Seed and Lint Indices

Freddie M. Bourland¹, Don C Jones² and Edward M. Barnes², (1)University of Arkansas, Keiser, AR, (2)Cotton Incorporated, Cary, NC

**COTTON IMPROVEMENT
WEDNESDAY LATE AFTERNOON**

Salon I - 4:00 PM-5:00 PM

4:00 PM John Deere Operations Center - Manage Cotton Data More Efficiently Than Ever before

Kayla Becker, John Deere, Ankeny, IA

4:15 PM Dyna-Gro New Cotton Varieties for 2022

Frank Groves, Nutrien, Little Rock, AR

4:30 PM Response of Leaf Chlorophyll Content to High Heat and Low-Soil Water in the Arizona Low Desert

Alison L Thompson¹, Matthew M. Conley², Matthew T Herritt¹ and Kelly R. Thorp², (1)USDA-ARS-ALARC, Maricopa, AZ, (2)USDA-ARS, Maricopa, AZ

4:45 PM Data-Driven Systematics: Phylogeography of the USDA Extra Long Staple (*Gossypium barbadense*) Collection.

John Gottula¹, Rachael Depolt¹ and Joshua Udall², (1)SAS Institute, Cary, NC, (2)USDA-ARS, College Station, TX

Cotton Insect Research and Control Conference

**COTTON INSECT RESEARCH & CONTROL CONF.
WEDNESDAY EARLY MORNING
MS STUDENT PAPER COMPETITION (SESSION A)**

Salons C-D - 8:00 AM-10:15 AM

8:00 AM Evaluating the Efficacy of Foliar-Applied Insecticides in Tobacco Thrips Populations

Jessica Loren Krob and Scott D. Stewart, University of Tennessee, Jackson, TN

8:15 AM Benefits of Neonicotinoid Seed Treatments on Thryvon Cotton

Walker Brett Farmer¹, Tyler Parker¹, Angus Catchot¹, Jeff Gore², Whitney Crow² and Don Cook², (1)Mississippi State University, Starkville, MS, (2) Mississippi State University, Stoneville, MS

8:30 AM Evaluation of Thryvon Technology for Control of Thrips and Tarnished Plant Bugs in Cotton

Adam Whitfield¹, Gus Lorenz², Benjamin C Thrash², Nick R. Bateman³, Matthew G Mann², Garrett Felts⁴, Andrew Plummer⁵, Chase A Floyd², Caleb Rice², Trevor B Newkirk⁶, Zack Murray⁷ and Taylor A Harris⁸, (1)UA-CES, Lonoke, AR, (2)University of Arkansas, Lonoke, AR, (3)University of Arkansas - RREC, Stuttgart, AR, (4)University of Arkansas- RREC, Stuttgart, AR, (5)University of Arkansas CES, Lonoke, AR, (6)University of Arkansas, Stuttgart, AR, (7) University of Arkansas, Fayetteville, AR, (8)UADA, Lonoke, AR

8:45 AM A Look at Early Season Management Methods of Tarnished Plant Bugs

James Michael Huoni¹, Jeff Gore², Don Cook², Angus Catchot³ and Whitney Crow², (1)Delta Research and Extension Center, Stoneville, MS, (2)Mississippi State University, Stoneville, MS, (3)Mississippi State University, Mississippi State, MS

9:00 AM Late Season Management of Tarnished Plant Bugs in Cotton

Seth T Permenter¹, Whitney Crow², Jeff Gore², Angus Catchot³ and Don Cook², (1)Delta Research and Extension Center, Stoneville, MS, (2)Mississippi State University, Stoneville, MS, (3)Mississippi State University, Mississippi State, MS

9:15 AM The Impact of Insecticide Rotations Targeting Tarnished Plant Bugs (*Lygus Lineolaris*) on Beneficial Insects in Virginia Cotton
John Philip Schepis, Virginia Tech University, Rockville, MD, Anders S. Huseeth, North Carolina State University, Raleigh, NC, Dominic Reisig, North Carolina State University, Plymouth, NC and Sally Taylor, Virginia Tech University, Suffolk, VA

9:30 AM Cotton Volatiles and Injury Response Stimulated by Feeding of Sucking Bugs.
Malek A Alwedyan, Texas A&M University, Corpus Christi, TX, Angel Helms, Texas A&M University, College Station, TX and Michael J. Brewer, Texas A&M AgriLife Research, Department of Entomology, Corpus Christi, TX

9:45 AM Evaluating Pyrethroid Resistance in *Oeobius Pugnax* (F.) in the Texas Coastal Bend
Danielle Gray, Texas A&M University, College Station, TX, Stephen Biles, Texas A&M AgriLife Extension Service, Port Lavaca, TX, Kate Crumley, Texas A&M AgriLife Extension Service, Wharton, TX, Tyler Mays, Texas A&M AgriLife Extension Service, Hillsboro, TX, Sebe Brown, LSU AgCenter, Winnsboro, LA, David L Kerns, Texas A&M AgriLife Extension, College Station, TX and Dalton Ludwick, Texas A&M AgriLife Extension, Corpus Christi, TX

10:00 AM Monitoring Potential Lambda-Cyhalothrin Resistance in Rice Stink Bug, *Oeobius Pugnax* Populations in Arkansas
Trevor B Newkirk, University of Arkansas, Stuttgart, AR

COTTON INSECT RESEARCH & CONTROL ROUNDTABLE

Salons C-D – 11:00 AM-12:00 PM

COTTON INSECT RESEARCH & CONTROL CONF. WEDNESDAY EARLY AFTERNOON MS STUDENT PAPER COMPETITION (SESSION B)

Salon G - 1:30 PM-3:15 PM

1:30 PM Value of IPM in Protecting Cotton Profitability in Tennessee
Claire Cooke¹, Scott D. Stewart¹, Sandy Steckel² and Matthew Williams¹, (1)University of Tennessee, Jackson, TN, (2)The University of Tennessee, Jackson, TN

1:45 PM Adult Bollworm Moth Control to Prevent Economical Yield Loss in Cotton
Walker Brett Farmer¹, Jeff Gore², Angus Catchot¹, Whitney Crow², Don Cook², Brian Pieralisi¹ and Beverly Catchot³, (1)Mississippi State University, Starkville, MS, (2)Mississippi State University, Stoneville, MS, (3)Mississippi State University, Mississippi State, MS

2:00 PM Comparison of Transgenic Bt Technologies in Arkansas Cotton Systems for Control of Cotton Bollworm, *Helicoverpa Zea*.
Zack Murray¹, Gus Lorenz², Benjamin C Thrash², Nick R. Bateman³, Andrew Plummer⁴, Matthew G Mann², Garrett Felts⁵, Chase A Floyd², Caleb Rice², Trevor Newkirk², Adam Whitfield⁶ and T. Harris², (1)University of Arkansas, Fayetteville, AR, (2)University of Arkansas, Lonoke, AR, (3)University of Arkansas - RREC, Stuttgart, AR, (4)University of Arkansas CES, Lonoke, AR, (5)University of Arkansas- RREC, Stuttgart, AR, (6)UA-CES, Lonoke, AR

2:15 PM Residual of NPV and Feeding Habits after Ingestion
Judge Tyler Fortenberry¹, Angus Catchot¹, Don Cook², Whitney Crow², Jeff Gore² and Beverly Catchot³, (1)Mississippi State University, Starkville, MS, (2)Mississippi State University, Stoneville, MS, (3)Mississippi State University, Mississippi State, MS

2:30 PM Utility of GS-Omega/Kappa-Hxtx-Hv1a Peptide (Spear-T) for Mitigating Helicoverpa Zea Bt Cry Protein Resistance in Dual-Gene Bt Cotton

Simeon L Ross, Texas A&M AgriLife, College station, TX

2:45 PM Determining Chlorantraniliprole Translocative Activity in Cotton Flowers

Jacob Smith¹, Whitney Crow¹, Angus Catchot², Jeff Gore¹ and Don Cook¹, (1) Mississippi State University, Stoneville, MS, (2)Mississippi State University, Mississippi State, MS

3:00 PM Relationship between Growing Degree Days and Nodes Above White Flower to Predict Insecticide Termination

Eli B. Hobbs¹, Darrin M. Dodds¹, Brian K. Pieralisi², Angus Catchot¹, Justin McCoy³, Hunter Perry⁴, Bradley Norris¹, Tyler S Soignier² and William Joseph Rutland², (1)Mississippi State University, Mississippi State, MS, (2)Mississippi State University, Starkville, MS, (3)Mississippi State Univ, Verona, MS, (4) Corteva Agriscience, Leland, MS

**COTTON INSECT RESEARCH & CONTROL CONF.
WEDNESDAY EARLY AFTERNOON
PHD STUDENT PAPER COMPETITION (SESSION A)**

Salons C-D - 1:30 PM-3:15 PM

1:30 PM Gene Editing Approaches for Cotton Pest Management

Mason Clark¹, Spencer Behmer¹, Angel Helms¹, Mike Thomson¹, Kent Chapman², Kater Hake³ and Keyan Zhu-Szalmán¹, (1)Texas A&M University, College Station, TX, (2)University of North Texas, Denton, TX, (3)Cotton Incorporated, Cary, NC

1:45 PM Evaluation of Thryvon Cotton as a Control Method of Cotton Fleahoppers (*Pseudatomocelis seriatus* Reuter)

Brady P. Arthur¹, David Kerns¹ and Holly Davis², (1)Texas A&M University, College Station, TX, (2)Texas A&M University, Weslaco, TX

2:00 PM Thrips Management in Alabama Cotton

Thomas J Douglas and Scott H. Graham, Auburn University, Auburn University, AL

2:15 PM Investigating the Potential for Utilizing Grain Sorghum as a Nursery Crop for Hearnpv Dissemination into Cotton

Wilfrid Calvin¹, David Kerns¹, Jeff Gore², Jeremy Greene³, Suhas Vyavhare⁴, Megha N. Parajulee⁵, Ronnie Schnell⁶ and Lindsey C Perkin⁷, (1)Texas A&M University, College Station, TX, (2)Mississippi State University, Stoneville, MS, (3)Clemson University, Blackville, SC, (4)Texas A&M AgriLife Research Center, Lubbock, TX, (5)Texas A&M AgriLife Research and Extension Center, Lubbock, TX, (6)Texas A&M AgriLife Extension Service, College Station, TX, (7)USDA-ARS ICCDRU, College Station, TX

2:30 PM Evaluation of Insecticide Seed Treatments in Furrow Irrigated Rice for Control of Rice Billbug, *Sphenophorus Pertinax*, in Arkansas

Chase A Floyd¹, Gus Lorenz¹, Nick R. Bateman², Benjamin C Thrash¹, Garrett Felts³, Andrew Plummer⁴, Matthew G Mann⁵, Caleb Rice¹, Trevor Newkirk¹, Adam Whitfield⁶, Zack Murray⁷ and Taylor A Harris⁸, (1)University of Arkansas, Lonoke, AR, (2)University of Arkansas - RREC, Stuttgart, AR, (3)University of Arkansas- RREC, Stuttgart, AR, (4)University of Arkansas CES, Lonoke, AR, (5)University of Arkansas, Lonoke, AR, University of Arkansas, Lonoke, AR, (6)UA-CES, Lonoke, AR, (7)University of Arkansas, Fayetteville, AR, (8)UADA, Lonoke, AR

2:45 PM Monitoring Seasonal Dynamics and Community Composition of Cotton Infesting Aphid Species in the Southern U.S.

John W. Mahas¹, Alana Lynn Jacobson¹, Charles Ray¹, Jessica B. Mahas¹, Michael Toews², Phillip Roberts², Jeremy Greene³, George G. Kennedy⁴, Sally Taylor⁵, Silvana Paula-Moraes⁶, Jeff Gore⁷, Whitney Crow⁷, Scott D. Stewart⁸, David Kerns⁹ and Suhas Vyavhare¹⁰, (1)Auburn University, Auburn, AL, (2) University of Georgia, Tifton, GA, (3)Clemson University, Blackville, SC, (4) North Carolina State University, Raleigh, NC, (5)Virginia Tech University, Suffolk, VA, (6)University of Florida, Jay, FL, (7)Mississippi State University, Stoneville, MS, (8)University of Tennessee, Jackson, TN, (9)Texas A&M University, College Station, TX, (10)Texas A&M AgriLife Research, Lubbock, TX

3:00 PM Detached Leaf Vs. Intact Plant Herbivory Bioassays: A Meta-Analysis

Leah Buchman, Texas A&M University, Department of Entomology, College Station, TX, James Alfieri, Texas A&M University, Interdisciplinary Program in Ecology and Evolutionary Biology, College Station, TX and Gregory A. Sword, Texas A&M University, College Station, TX

**COTTON INSECT RESEARCH & CONTROL CONF.
WEDNESDAY LATE AFTERNOON
PHD STUDENT PAPER COMPETITION (SESSION B)
& GENERAL SESSION A**

Salons C-D - 3:30 PM-5:30 PM

3:30 PM Marker-Assisted Fall Armyworm Breeding: Leveraging Novel, Real-Time Genotyping Techniques to Better Characterize C-Strain, R-Strain, and Hybridized Spodoptera Frugiperda.

Andie Miller, Ashley Tessnow and Gregory A. Sword, Texas A&M University, College Station, TX

3:45 PM Binding of Vip3A Toxin to Resistant and Susceptible Helicoverpa Zea Brush Border Membrane Vesicles

Dawson Kerns¹, Fei Yang², David Kerns², Scott D. Stewart³ and Juan Luis Jurat-Fuentes¹, (1)University of Tennessee, Knoxville, TN, (2)Texas A&M University, College Station, TX, (3)University of Tennessee, Jackson, TN

4:00 PM Fitness Costs Associated with Vip3A Resistance in Helicoverpa Zea

Haley D Kennedy¹, Fei Yang¹ and David L Kerns², (1)Texas A&M University, College Station, TX, (2)Texas A&M AgriLife Extension, College Station, TX

4:15 PM Impact of Plant-Associated Fungi on Boll Weevil Reproduction

Janaina Camara Siqueira da Cunha and Gregory A. Sword, Texas A&M University, College Station, TX

4:30 PM Development of Rapid Diagnostic Tools for the Identification of Anthonomus grandis and Related Species

Tyler Jay Raszick¹, Lindsey C Perkin², Alejandra Godoy³, Raul Ruiz-Arce³, Charles P.-C. Suh², Xanthe A. Shirley⁴ and Gregory A. Sword¹, (1)Texas A&M University, College Station, TX, (2)USDA-ARS ICCDRU, College Station, TX, (3) USDA-APHIS, Edinburg, TX, (4)USDA-APHIS, College Station, TX

4:45 PM Identifying Cotton Fields Using Satellite Imagery and Machine Learning Techniques for Advancing Boll Weevil Eradication

Chenghai Yang, USDA-ARS, College Station, TX and Charles P.-C. Suh, USDA-ARS ICCDRU, College Station, TX

5:00 PM An Integrative Analysis of Cotton - Fungal - Aphid Interactions.

Cesar U Valencia, Texas A&M Entomology Department, College Station, TX and Gregory A. Sword, Texas A&M University, College Station, TX

5:15 PM Effects of Insecticides at Planting on Early Developing Populations of Cotton Aphid

Jeremy Greene¹, Francis Reay-Jones², Phillip Roberts³, Dominic Reisig⁴, Anders S. Huseth⁵, Sally Taylor⁶, Alana Lynn Jacobson⁷, Scott Graham⁷, Ron H. Smith⁷ and Silvana Paula-Moraes⁸, (1)Clemson University, Blackville, SC, (2)Clemson University, Florence, SC, (3)University of Georgia, Tifton, GA, (4)North Carolina State University, Plymouth, NC, (5)North Carolina State University, Raleigh, NC, (6)Virginia Tech University, Suffolk, VA, (7)Auburn University, Auburn, AL, (8)University of Florida, Jay, FL

**COTTON INSECT RESEARCH & CONTROL CONF.
WEDNESDAY LATE AFTERNOON
MS STUDENT PAPER COMPETITION (SESSION C)**

Salon G - 4:00 PM-5:30 PM

4:00 PM Quantifying Overwintering Site Selection and Survival of Redbanded Stink Bug, a Pest of Soybean

Thomas G Paul¹, Angus Catchot¹, Samuel F Ward², Priyadarshini C Basu¹ and Fred R Musser¹, (1)Mississippi State University, Mississippi State, MS, (2)Mississippi State, Mississippi State, MS

4:15 PM Comparison of Chrysogen Formulations for Control of Soybean Looper, Chrysodeixis Includens, in Arkansas Soybean Production

Caleb Rice¹, Gus Lorenz¹, Benjamin C Thrash¹, Nick R. Bateman², Garrett Felts³, Andrew Plummer⁴, Chase A Floyd¹, Trevor B Newkirk⁵, Adam Whitfield⁶, Zack Murray⁷ and Taylor A Harris⁸, (1)University of Arkansas, Lonoke, AR, (2)University of Arkansas - RREC, Stuttgart, AR, (3)University of Arkansas-RREC, Stuttgart, AR, (4)University of Arkansas CES, Lonoke, AR, (5)University of Arkansas, Stuttgart, AR, (6)UA-CES, Lonoke, AR, (7)University of Arkansas, Fayetteville, AR, (8)UADA, Lonoke, AR

4:30 PM Effects of Water Quality on Insecticide Performance for the Control of Tarnished Plant Bug, Lygus lineolaris, in Cotton and Corn Earworm, Helioverpa zea, in Soybeans

Taylor A Harris¹, Gus Lorenz², Benjamin C Thrash², Nick R. Bateman³, Matthew G Mann², Andrew Plummer⁴, Chase A Floyd², Caleb Rice², Garrett Felts⁵, Trevor B Newkirk⁶, Adam Whitfield⁷ and Zack Murray⁸, (1)UADA, Lonoke, AR, (2)University of Arkansas, Lonoke, AR, (3)University of Arkansas - RREC, Stuttgart, AR, (4)University of Arkansas CES, Lonoke, AR, (5)University of Arkansas-RREC, Stuttgart, AR, (6)University of Arkansas, Stuttgart, AR, (7)UA-CES, Lonoke, AR, (8)University of Arkansas, Fayetteville, AR

4:45 PM Exploring Chemical Management of Threecornered Alfalfa Hopper in Mid-Atlantic US Soybean

Elizabeth Pittman, Virginia Cooperative Extension, Suffolk, VA and Sally Taylor, Virginia Tech University, Suffolk, VA

5:00 PM Investigating the Interaction of Plant Age and Timing of Cotton Leafroll Dwarf Virus Infection on Yield Loss

Kelly Schlarbaum, Kassie Conner, Adam Kesheimer and Alana Lynn Jacobson, Auburn University, Auburn, AL

5:15 PM Enhancing Beauveria Bassiana Aphid Control Efficacy by Enriching Spore Suspension with Molasses

Elise B Woodruff, Texas A&M University Department of Entomology, College Station, TX

**COTTON INSECT RESEARCH & CONTROL
BUSINESS MEETING AND MIXER**

Salon G - 5:30 PM-7:00 PM

Cotton Quality Measurements Conference

COTTON QUALITY MEASUREMENTS

Conf. Room 8 - 2:15 PM-5:00 PM

2:15 PM Reconstruction of Complete Fiber Length Distribution from HVI Fibrogram

Christopher N Turner, Md Abu Sayeed and Eric F. Hequet, Texas Tech University, Lubbock, TX

2:30 PM Procedure to Correct the High-Volume Instrument Fibrogram

Addisu Ferede Tesema¹, Md Abu Sayeed¹, Christopher N Turner¹, Brendan Kelly² and Eric F. Hequet¹, (1)Texas Tech University, Lubbock, TX, (2)Texas A&M Agrilife Research, Lubbock, TX

2:45 PM Calculating the Uniformity of Cotton Fiber Length Using the Complete HVI Fibrogram

Md Abu Sayeed, Christopher N Turner and Eric F. Hequet, Texas Tech University, Lubbock, TX

3:00 PM Use of Fiber Length Parameters from HVI and AFIS to Predict Yarn Quality

MD Rashedul Hasan, Christopher N Turner, Md Abu Sayeed and Eric F. Hequet, Texas Tech University, Lubbock, TX

3:15 PM Vortex Spinning of Elite Germplasm

Eric F. Hequet, Texas Tech University, Lubbock, TX and Wayne Smith, Texas A&M University, College Station, TX

3:30 PM Break

3:45 PM A New Imaging Modality for High-Throughput Imaging of Cotton Fibers

Reagan B Heinrich¹, Brooke E Shumate², **Brendan Kelly**³, Alexandre Soares-Da-Silva¹, Yildirim Kocoglu¹, Hamed Sari-Sarraf¹, Md Alamgir Kabir⁴ and Aniruddha Ray⁴, (1)Texas Tech University, Lubbock, TX, (2)Texas A&M Agrilife, Lubbock, TX, (3)Texas A&M Agrilife Research, Lubbock, TX, (4)University of Toledo, Toledo, OH

4:00 PM In Situ Color and Leaf Measurement of Cotton Bales

Christopher D. Delhom, USDA-ARS Southern Regional Research Center, New Orleans, LA

4:15 PM The Relevance of Color Grade to Yarn Manufacturing

Marinus H.J van der Sluijs, Textile Technical Services, Geelong, VIC, Australia

4:30 PM Comparative Investigation of Fiber Maturity in Seed Cottons by Cottonscope and Fourier Transform Infrared Spectroscopy Measurement

Yongliang Liu, USDA-ARS, SRRC, New Orleans, LA and Christopher D. Delhom, USDA-ARS Southern Regional Research Center, New Orleans, LA

Cotton Utilization Conference

COTTON UTILIZATION

Conf. Room 8 - 10:30 AM-12:00 PM

10:30 AM Formation of Peanut Butter-like Products from Glandless Cottonseed

Zhongqi He¹, Huai N Cheng¹ and Jibao He², (1)USDA-ARS SRRC, New Orleans, LA, (2)Tulane University Coordinated Instrumentation Facility, New Orleans, LA

10:50 AM Survey of Cottonseed Extracts on Gene Expression in Mammalian Cells

Heping Cao, USDA-ARS, New Orleans, LA and Kandan Sethumadhavan, USDA-ARS-SRRC, New Orleans, LA

11:10 AM Preparation and Characterization of Xylan Derivatives

Huai N Cheng¹, Catrina Ford¹, Zhongqi He¹, Atanu Biswas² and Qinglin Wu³, (1)USDA-ARS SRRC, New Orleans, LA, (2)USDA Agricultural Research Svc, Peoria, IL, (3)Louisiana State University, Baton Rouge, LA

11:30 AM Post-Pandemic Trends in Cotton Textile Utilization

Mourad Krifa, Kent State University, Kent, OH

Cotton Weed Science Research Conference

COTTON WEED SCIENCE RESEARCH WEDNESDAY EARLY MORNING

Salon J - 8:00 AM-10:00 AM

8:00 AM Introductory Remark

8:15 AM When the Auxins Get Tough, the Palmer Gets Going

Delaney C. Foster and Larry Steckel, University of Tennessee, Jackson, TN

8:30 AM Johnsongrass Resistance to Glyphosate and Aryloxyphenoxypropionate Herbicides: Implications for Management in Cotton

Jacob A Fleming¹, Jason K Norsworthy¹, Muthukumar V Bagavathiannan², Vipin Kumar³, Misha R. Manuchehri⁴, Tom Barber⁵ and Thomas R Butts⁶, (1) University of Arkansas, Fayetteville, AR, (2)Texas A&M University, College Station, TX, (3)Kansas State University, Manhattan, KS, (4)Oklahoma State University, Stillwater, OK, (5)University of Arkansas-Extension, Lonoke, AR, (6)University of Arkansas, Lonoke, AR

8:45 AM Addition of Glutathione S-Transferase Inhibitors to Glufosinate: Is This an Option for Controlling Glufosinate-Resistant Palmer Amaranth?

Pamela Carvalho-Moore¹, Jason K. Norsworthy¹, Fidel Gonzalez-Torralva¹, Tom Barber², Maria Leticia Zaccaro-Gruener¹ and Leonard B Piveta¹, (1) University of Arkansas, Fayetteville, AR, (2)University of Arkansas-Extension, Lonoke, AR

9:00 AM Impact of Weed Management Practices over a Three-Year Period on Palmer Amaranth Population in Cotton

Ty C Smith¹, Jason K Norsworthy¹, Tom Barber² and Michael M. Houston¹, (1) University of Arkansas, Fayetteville, AR, (2)University of Arkansas-Extension, Lonoke, AR

9:15 AM Weed Management with Residual Herbicide Programs in Cotton

Zachary R. Treadway, Jennifer Dudak and Todd A Baughman, Oklahoma State University, Ardmore, OK

9:30 AM Large-Scale Evaluation of Enlist One Off-Target Movement: A Three-Year Summary

Navdeep Godara¹, Jason K Norsworthy¹, Lawson Priess¹, Leonard B Piveta¹, Michael M. Houston¹, Tom Barber² and Thomas R Butts³, (1)University of Arkansas, Fayetteville, AR, (2)University of Arkansas-Extension, Lonoke, AR, (3)University of Arkansas, Lonoke, AR

9:45 AM Comparison of Alite 27 Herbicide Programs in GLIXTP Cotton

Jennifer Dudak¹, Zachary R. Treadway¹, Todd A Baughman¹, Tom Barber², Charlie Cahoon³, A. Stanley Culpepper⁴, Michael W. Marshall⁵, Scott Nolte⁶ and Adam C Hixon⁷, (1)Oklahoma State University, Ardmore, OK, (2)University of Arkansas-Extension, Lonoke, AR, (3)North Carolina State University, Raleigh, NC, (4)University of Georgia, Tifton, GA, (5)Clemson University - Edisto REC, Blackville, SC, (6)Texas A&M University, College Station, TX, (7)BASF, Lubbock, TX

**COTTON WEED SCIENCE RESEARCH
WEDNESDAY LATE MORNING**

Salon J - 10:30 AM-12:00 PM

10:30 AM Are Georgia Farmers Losing the Ability to Manage Palmer Amaranth with PPO-Inhibiting Herbicides Applied PRE and POST?

Taylor M Randell, Lavesta C. Hand, Jenna C Vance, Hannah Wright and A. Stanley Culpepper, University of Georgia, Tifton, GA

10:45 AM Application Technology Comparison for Season-Long Weed Control in Midsouth Cotton

Michael M. Houston¹, Jason K Norsworthy¹, William Patzoldt², Jacob Fleming¹, Ty C Smith¹ and Tom Barber³, (1)University of Arkansas, Fayetteville, AR, (2)Blue River Technology, Sunnyvale, CA, (3)University of Arkansas-Extension, Lonoke, AR

11:00 AM Evaluating an Integrated Approach to Palmer Amaranth Management in Southern US Cotton

Sarah E. Kezar¹, Delaney C. Foster², Sandy Ramsey³, Fernando Oreja³, Kyle Russell², Michael Houston⁴, Daniel Hathcoat¹, Ramon Leon Gonzalez³, Jason K Norsworthy⁴, Peter A. Dotray², Gaylon Morgan⁵ and Muthukumar V Bagavathiannan¹, (1)Texas A&M University, College Station, TX, (2)Texas Tech University, Texas A&M AgriLife Research and Extension Service, Lubbock, TX, (3)North Carolina State University, Raleigh, NC, (4)University of Arkansas, Fayetteville, AR, (5)Cotton Incorporated, Cary, NC

11:15 AM Palmer Amaranth Control with Engenia/Liberty Tank-Mixes and Sequential Applications

C.D. Ray White, Texas A&M AgriLife Research, Lubbock, TX, J. Wayne Keeling, Texas A&M AgriLife Research Center, Lubbock, TX and Justin Lee Spradley, Texas A&M AgriLife, Lubbock, TX

11:30 AM Cotton Fiber Quality Response to Low Rates of 2,4-D

Kyle Russell, Texas Tech University, Lubbock, TX, Texas A&M AgriLife Research, Lubbock, TX, Peter A. Dotray, Texas Tech University, Texas A&M AgriLife Research and Extension Service, Lubbock, TX and Brendan Kelly, Texas A&M AgriLife Research, Lubbock, TX

Sustainability

COTTON SUSTAINABILITY WEDNESDAY EARLY MORNING

Salon L - 8:00 AM-10:00 AM

8:00 AM US Cotton Sustainability

Gary Adams, National Cotton Council, Cordova, TN

8:30 AM US Cotton Trust Protocol - Industry Connectivity and Research Initiatives

Ken Burton, National Cotton Council, Cordova, TN and Andrew Jordan, Jordan Associates Ag and Bio Engineering Services, Cordova, TN

8:50 AM US Cotton Trust Protocol - Verification

Viviana Pagan, Control Union, Savannah, GA

9:15 AM US Cotton Trust Protocol: Hear Direct from the Growers (Panel Discussion)

Ken Burton, National Cotton Council, Cordova, TN

COTTON SUSTAINABILITY WEDNESDAY LATE MORNING

Salon L - 10:30 AM-12:00 PM

10:30 AM The Growing Need for Sustainably Sourced Cotton: Hear from the Brands (Panel Discussion)

Steven Pires, Cotton Incorporated, Cary, NC

11:15 AM Textile Exchange 2030 Strategy: Climate+

La Rhea Pepper, Textile Exchange, Lander, WY

COTTON SUSTAINABILITY WEDNESDAY EARLY AFTERNOON

Salon L - 1:00 PM-3:15 PM

1:00 PM Trends in US Cotton Sustainability: 2021 Field to Market National Indicators Report

Eric Coronel, Field to Market, Washington, DC, DC

1:30 PM Opportunities and Challenges for Improving US Cotton Sustainability: Hear from the Experts (Panel Discussion)

Andrew Jordan, Jordan Associates Ag and Bio Engineering Services, Cordova, TN

2:15 PM Future Challenges for Cotton in the European Union

Michele L Wallace and Jesse Daystar, Cotton Incorporated, Cary, NC

2:45 PM Organic Cotton in the US

Sandra Marquardt, Textile Exchange, Silver Spring, MD and Andrew Jordan, Jordan Associates Ag and Bio Engineering Services, Cordova, TN

COTTON SUSTAINABILITY WEDNESDAY LATE AFTERNOON

Salon L - 4:00 PM-5:00 PM

4:00 PM Ecosystem Services and Carbon Markets: Hear from Experience (Panel Discussion)

Jesse Daystar, Cotton Incorporated, Cary, NC

4:45 PM Introducing the U.S. Regenerative Cotton Fund

Dianna Bagnall¹, Nate Looker², Mary Griffith², David Lamm² and Cristine Morgan², (1)Soil Health Institute, Columbia, IL, (2)Soil Health Institute, Morrisville, NC

Cotton Agronomy, Physiology & Soil Conference

COTTON AGRONOMY, PHYSIOLOGY & SOILS - AWARDS

Salon A - 9:00 AM-10:30 AM

Cotton Disease Council

COTTON DISEASE COUNCIL
THURSDAY EARLY MORNING

Conf. Room 16-17 - 8:00 AM-10:00 AM

8:00 AM Evaluating Fusarium Race 4 Resistance

Jim Olvey¹, Mike Olvey¹ and Don C Jones², (1)O&A Enterprises, Maricopa, AZ, (2)Cotton Incorporated, Cary, NC

8:15 AM Study of Fusarium Wilt in Cotton, New Findings in the Management Front

Cecilia Monclova-Santana, Texas A&M AgriLife Extension, Lubbock, TX and Terry A. Wheeler, Texas A&M AgriLife Research, Lubbock, TX

8:30 AM Variety Response to Verticillium Wilt and Bacterial Blight in the Southern High Plains of Texas

Terry A. Wheeler, Texas A&M AgriLife Research, Lubbock, TX, Jane K Dever, Texas A&M AgriLife Research and Extension Center, Lubbock, TX and Cecilia Monclova-Santana, Texas A&M AgriLife Extension, Lubbock, TX

8:45 AM Cotton Leafroll Dwarf Virus: Opening the Locks in Georgia

Sudeep Bag, Phillip Roberts, Robert Kemerait and Peng Chee, University of Georgia, Tifton, GA

9:00 AM Cotton Leafroll Dwarf Virus Isolates in the US Comprise Divergent Subpopulations and Harbor Extensive Genomic Variability

Judith K Brown¹, Raphael O Adegbola¹, Kathy Lawrence² and Olufemi Alabi³, (1)University of Arizona, Tucson, AZ, (2)Auburn University, Auburn, AL, (3)Dept of PI Pathol & Microbiol, Weslaco, TX

9:15 AM Results from the 2021 CLRDV Sentinel Plots in AL, FL, GA, SC, NC, VA, MS, AR, LA, TN, and TX and Resistance Screening Efforts at Auburn University

Marcio Zaccaron¹, Jenny Koebernick¹, Delaney Roark¹, Sally Taylor², Anders S. Huseeth³, Jeremy Greene⁴, Robert Kemerait⁵, Ian Small⁶, Kassie Conner¹, Kira L. Bowen¹, Paul Price⁷, Thomas W. Allen⁸, Travis R. Faske⁹ and David Kerns¹⁰, (1)Auburn University, Auburn, AL, (2)Virginia Tech University, Suffolk, VA, (3)North Carolina State University, Raleigh, NC, (4)Clemson University, Blackville, SC, (5)University of Georgia, Tifton, GA, (6)University of Florida, Quincy, FL, (7)Louisiana State University, Winnsboro, LA, (8)Mississippi State University, Mississippi State, MS, (9)University of Arkansas Division of Agriculture, Lonoke, AR, (10)Texas A&M University, College Station, TX

9:30 AM Cotton Leafroll Dwarf Virus Incidence as Impacted by Planting Date and Cotton Cultivar in Alabama

Amanda Strayer-Scherer¹, Austin K Hagan¹, Katherine Burch¹, Kassie Conner¹, Steve M Brown², Jenny Koebernick¹, Marcio Zaccaron¹, H. Brad Miller³ and Joshua Canterbury⁴, (1)Auburn University, Auburn, AL, (2)Auburn University, Auburn University, AL, (3)Brewton Agricultural Research Unit, Brewton, AL, (4)Auburn University, Prattville Ag Research Ctr, Prattville, AL

Thursday, January 6, 2022

**COTTON DISEASE COUNCIL
THURSDAY LATE MORNING**

Conf. Room 16-17 - 10:30 AM-12:00 PM

10:30 AM Surveillance of Cotton Leafroll Dwarf Virus (CLRDV) in Cotton Growing Regions of the United States Using Molecular Diagnostics and Phylogeny of ORF0 and ORF4 Virus Genes

Raphael O Adegbola¹, Noel T Kitchen¹, Kathy Lawrence², Kassie Conner² and Judith K Brown¹, (1)University of Arizona, Tucson, AZ, (2)Auburn University, Auburn, AL

10:45 AM Disease Intensity, Yield, and Loan Value as Influenced by Cotton Cultivar Selection Along with Plant Growth Regulator and Fungicide Inputs

Austin K Hagan¹, Amanda Strayer-Scherer¹, Katherine Burch¹ and H. Brad Miller², (1)Auburn University, Auburn, AL, (2)Brewton Agricultural Research Unit, Brewton, AL

11:00 AM Three-Year Evaluation of Fungicides for Management of Cotton Leaf Diseases in Colquitt County

Jeremy M Kichler, UGA Cooperative Extension, Moultrie, GA and Robert Kemeraite, University of Georgia, Tifton, GA

11:15 AM Adding Operational Context to Pest/Disease Management Decision Support Tools

Thomas M. Chappell, Texas A&M University, College Station, TX

Cotton Ginning Conference

**JOINT SESSION: COTTON ENGINEERING SYSTEMS
AND COTTON GINNING**

Salon K - 8:00 AM-10:00 AM

8:00 AM John Deere C770 Cotton Harvesters

Christopher Murray, John Deere Des Moines Works, Ankeny, IA

8:15 AM Experimental Investigation on Seed Cotton Conveyance and Drying for Improving Energy Efficiency

Sunil Kumar, Robert G. Hardin and Maria D. King, Texas A&M University, College Station, TX

8:30 AM Numerical Investigation on Drying of Large Cotton Lumps

Sunil Kumar, Maria D. King and Robert G. Hardin, Texas A&M University, College Station, TX

8:45 AM Acquiring Tabletop and Breeder Gin Energy

Sean Donohoe, Cody D. Blake and Joe W. Thomas, USDA ARS, Stoneville, MS

9:00 AM Parameter Optimization of a Brush-Based Plastic Removal Mechanism for Cotton Gins

Adeyemi Adeleke and Robert G. Hardin, Texas A&M University, College Station, TX

9:15 AM Plastic Fate in the Gin

Roy J Graves, Texas A&M University, College Station, TX

9:30 AM Effect of Moisture Content on Cottonseed Shear Strength

Caleb Riehl¹, J. Alex Thomasson² and Robert G. Hardin¹, (1)Texas A&M University, College Station, TX, (2)Mississippi State University, Starkville, MS

9:45 AM A CNN-Based Approach to Detect Cover Damage of Round Cotton Modules

Md Zafar Iqbal¹, Robert G. Hardin¹, Tianyi Wang², Jason K. Ward³ and John D. Wanjura⁴, (1)Texas A&M University, College Station, TX, (2)Texas A&M AgriLife Research, Dallas, TX, (3)North Carolina State University, Raleigh, NC, (4)USDA-ARS Cotton Production and Processing Research Unit, Lubbock, TX

Cotton Improvement Conference

**COTTON IMPROVEMENT
BUSINESS MEETING**

Conf. Room 14 - 8:00 AM-8:30 AM

Cotton Insect Research and Control Conference

COTTON INSECT RESEARCH & CONTROL CONF. - THURSDAY EARLY MORNING - GENERAL SESSION B

Salon G - 8:00 AM-10:30 AM

8:00 AM Key Learnings From the 2021 Bayer ThryvOn™ Ground Breakers Trials

Timothy Dabbert, Bayer Crop Science, Creve Couer, MO

8:15 AM Experiences with Thryvon Cotton in Mississippi

Whitney Crow¹, Jeff Gore¹, Angus Catchot², Don Cook¹ and Jacob Smith¹, (1)Mississippi State University, Stoneville, MS, (2)Mississippi State University, Mississippi State, MS

8:30 AM Evaluation of Thryvon Cotton Against Thrips in Texas High Plains Cotton

Suhas Vyavhare, Texas A&M AgriLife Research Center, Lubbock, TX

8:45 AM Characterization of Lygus Feeding Behavior Using Electropenetrography

Abdul Hakeem¹, Megha N. Parajulee¹ and Dol P. Dhakal², (1)Texas A&M AgriLife Research and Extension Center, Lubbock, TX, (2)Texas A&M AgriLife Research Center, Lubbock, TX

9:00 AM Evaluation of Susceptibility to Tarnished Plant Bug in Cotton Cultivars Exhibiting Resistance Ultra-Small Plots

Glenn Studebaker¹, Fred M. Bourland² and Courtney J Spinks¹, (1)University of Arkansas, Keiser, AR, (2)University of Arkansas-NEREC, Keiser, AR

9:15 AM Crop Interface and Sampling Effects on *Lygus lineolaris* Populations in Southeastern Cotton

Anders S. Huseeth¹, Seth Dorman², Sally Taylor³, Sean Malone⁴, Phillip Roberts⁵, Jeremy Greene⁶, Dominic Reisig⁷, Ron H. Smith⁸, Alana Lynn Jacobson⁸, Francis Reay-Jones⁹ and Silvana Paula-Moraes¹⁰, (1)North Carolina State University, Raleigh, NC, (2)USDA-ARS, Forage Seed and Cereal Research Unit, Corvallis, OR, (3)Virginia Tech University, Suffolk, VA, (4)Virginia Tech, Suffolk, VA, (5)University of Georgia, Tifton, GA, (6)Clemson University, Blackville, SC, (7)North Carolina State University, Plymouth, NC, (8)Auburn University, Auburn, AL, (9)Clemson University, Florence, SC, (10)University of Florida, Jay, FL

9:30 AM Late Season Prevalence of Lygus Hesperus (Hemiptera: Miridae) in the Texas High Plains

Dol P. Dhakal¹, Megha N. Parajulee² and Abdul Hakeem², (1)Texas A&M AgriLife Research Center, Lubbock, TX, (2)Texas A&M AgriLife Research and Extension Center, Lubbock, TX

9:45 AM Cotton Pest Management in Deficit Irrigation Production Systems

Megha N. Parajulee¹, Dol P. Dhakal¹, Abdul Hakeem¹, Michael Toews², Katie L. Lewis¹, Suhas Vyavhare¹ and Donna McCallister¹, (1)Texas A&M AgriLife Research Center, Lubbock, TX, (2)University of Georgia, Tifton, GA

10:00 AM Managing Mirids with Isoclast in Western Cotton

Jesse M Richardson, Corteva Agriscience, Mesa, AZ, Sunil Tewari, Corteva Agriscience, Madera, CA, Patricia Prasifka, Corteva Agriscience, West Fargo, ND, Peter C Ellsworth, University of Arizona, Maricopa, AZ and Ian M Grettenberger, University of California-Davis, Davis, CA, CA

10:15 AM Residual Control of Stink Bugs and Leaf-footed Bug with Selected Insecticides

Jeremy Greene, Clemson University, Blackville, SC, Francis Reay-Jones, Clemson University, Florence, SC and Phillip Roberts, University of Georgia, Tifton, GA

**COTTON INSECT RESEARCH & CONTROL CONF.
THURSDAY EARLY MORNING - GENERAL SESSION C**

Salons C-D - 8:00 AM-10:30 AM

8:00 AM Timing of Bollworm Infestation across Cotton Planting Dates and Impacts on Yield in the Southeastern US

Dominic Reisig, North Carolina State University, Plymouth, NC, Jeremy Greene, Clemson University, Blackville, SC, Silvana Paula-Moraes, University of Florida, Jay, FL, Phillip Roberts, University of Georgia, Tifton, GA and Sally Taylor, Virginia Tech University, Suffolk, VA

8:15 AM Update on Bt Resistance in Helicoverpa Zea and the Value of Treating Bt Cotton with Insecticides

David L Kerns¹, Sebe Brown², Angus Catchot³, Don Cook⁴, Jose C. Santiago Gonzalez⁵, Jeff Gore⁴, Gus Lorenz⁶, Scott D. Stewart⁷, Glenn Studebaker⁸, Benjamin C Thrash⁶, Tyler B Towles² and Fei Yang⁵, (1)Texas A&M AgriLife Extension, College Station, TX, (2)LSU AgCenter, Winnsboro, LA, (3)Mississippi State University, Starkville, MS, (4)Mississippi State University, Stoneville, MS, (5)Texas A&M University, College Station, TX, (6)University of Arkansas, Lonoke, AR, (7)University of Tennessee, Jackson, TN, (8)University of Arkansas, Keiser, AR

8:30 AM Understanding the Risks Associated with Inheritance and Cross-Resistance in Cry and Vip3Aa Resistance of Helicoverpa Zea

Fei Yang, Texas A&M University, College Station, TX and David L Kerns, Texas A&M AgriLife Extension, College Station, TX

8:45 AM Characterization of Bollworm Junk DNA Associated with Cry1Ac Resistance

R. Michael Roe¹, Robert D. Mitchell III¹, Roger D Lawrie¹, Jean Marcel Degue-non¹, Loganathan Ponnusamy¹, Dominic Reisig², Alejandro Del Pozo-Valdivia³ and Ryan W Kurtz⁴, (1)North Carolina State University, Raleigh, NC, (2)North Carolina State University, Plymouth, NC, (3)University of California Cooperative Extension & UC Statewide IPM Program, Salinas, CA, (4)Cotton Incorporated, Cary, NC

9:00 AM Insecticide Resistance Monitoring for Bollworm and Soybean Looper

Fred R Musser and Beverly Catchot, Mississippi State University, Mississippi State, MS

9:15 AM Forget Corn and Rice, Fall Armyworm Strains Are Time-Associated Incipient Species That C- Come out Early and R- Really Late.

Gregory A. Sword¹, Ashley Tessnow¹, Andie Miller¹, Patrick Porter², Robert G. Hardin¹ and Roy Graves¹, (1)Texas A&M University, College Station, TX, (2) Texas A&M AgriLife Extension Service, Lubbock, TX

9:30 AM The Value of Standardized Insecticide Efficacy Trials across States

Jeff Gore¹, Whitney Crow¹, Angus Catchot², Don Cook¹, Tyler B Towles³, Sebe Brown³, Scott D. Stewart⁴, Gus Lorenz⁵, Benjamin C Thrash⁵, Nick R. Bateman⁶, Glenn Studebaker⁷, David Kerns⁸ and Fred Musser², (1)Mississippi State University, Stoneville, MS, (2)Mississippi State University, Mississippi State, MS, (3)LSU AgCenter, Winnsboro, LA, (4)University of Tennessee, Jackson, TN, (5)University of Arkansas, Lonoke, AR, (6)University of Arkansas - RREC, Stuttgart, AR, (7)University of Arkansas, Keiser, AR, (8)Texas A&M University, College Station, TX

9:45 AM Thrips Management in Mid-South Cotton

Don Cook¹, Scott D. Stewart², Whitney Crow¹, Jeff Gore¹, Benjamin C Thrash³, Gus Lorenz³, Angus Catchot⁴, David Kerns⁵, Sebe Brown⁶, Glenn Studebaker⁷, Tyler B Towles⁶ and Nick R. Bateman⁸, (1)Mississippi State University, Stoneville, MS, (2)University of Tennessee, Jackson, TN, (3)University of Arkansas, Lonoke, AR, (4)Mississippi State University, Mississippi State, MS, (5)Texas A&M University, College Station, TX, (6)LSU AgCenter, Winnsboro, LA, (7)University of Arkansas, Keiser, AR, (8)University of Arkansas - RREC, Stuttgart, AR

10:00 AM Utilizing Insecticide Seed Treatments and Starter Fertilizers to Reduce Thrips Injury in Cotton

Tyler B Towles¹, Wade Walker¹ and Sebe Brown², (1)LSU AgCenter, Winnsboro, LA, (2)University of Tennessee, Jackson, TN

10:15 AM Twospotted Spider Mite Management in Midsouth and Texas Cotton

Sebe Brown¹, Tyler B Towles², David Kerns³, Nick R. Bateman⁴, Benjamin C Thrash⁵, Gus Lorenz⁵, Glenn Studebaker⁶, Scott D. Stewart¹, Whitney Crow⁷, Don Cook⁷, Jeff Gore⁷ and Angus Catchot⁸, (1)University of Tennessee, Jackson, TN, (2)LSU AgCenter, Winnsboro, LA, (3)Texas A&M University, College Station, TX, (4)University of Arkansas - RREC, Stuttgart, AR, (5)University of Arkansas, Lonoke, AR, (6)University of Arkansas, Keiser, AR, (7)Mississippi State University, Stoneville, MS, (8)Mississippi State University, Mississippi State, MS

Cotton Weed Science Research Conference

COTTON WEED SCIENCE RESEARCH
GRADUATE STUDENT AWARDS

Salon J – 9:45 AM-10:15 AM

Sustainability

COTTON SUSTAINABILITY
THURSDAY EARLY MORNING

Salon L - 8:00 AM-10:00 AM

8:00 AM Evaluating Trends in Cotton and Peanut Sustainability Metrics Using the Fieldprint Calculator in Georgia

Kaylyn Groce and Wesley M Porter, University of Georgia, Tifton, GA

8:15 AM How Precision Agriculture Can Influence Environmental Outcomes

Chaz Holt, Quail Forever, St. Paul, MN

8:30 AM Nitrogen Management in Cotton: Environmental Implications and Updates

Katie L. Lewis, Texas A&M AgriLife Research and Extension Center, Lubbock, TX

8:45 AM Multiple Conservation Practices for Reducing Greenhouse Gas Emissions in Irrigated Cotton

Arlene A Adviento-Borbe, DWMRU USDA-ARS, Jonesboro, AR, Sandhya Karki, University of Arkansas, Jonesboro, AR, Tina Gray Teague, Ark State Univ / Univ Ark Sys Div of Ag, State University, AR and Michele L. Reba, USDA-ARS, Jonesboro, AR

9:00 AM Contextualizing Soil Health for Cotton Growers and Supply Chains

Dianna Bagnall¹, Nate Looker², Vance Almquist², Mary Griffith² and Cristine Morgan², (1)Soil Health Institute, Columbia, IL, (2)Soil Health Institute, Morrisville, NC

9:15 AM Soil Health after 40 Years of No-till and Cover Crops in a Continuous Cotton System in West Tennessee

Forbes R Walker, University of Tennessee Extension, Knoxville, TN

9:30 AM Student Poster Competition - Award Announcement

Lori Duncan, University of Tennessee, Knoxville, TN

Tuesday, January 4, 2022
Wednesday, January 5, 2022
Thursday, January 6, 2022

TECHNICAL CONFERENCES POSTER BOARD SESSION

TUESDAY, JANUARY 4, 2022, 8:00 AM - 8:00 PM
WEDNESDAY, JANUARY 5, 2022, 8:00 AM - 10:00 PM
THURSDAY, JANUARY 6, 2022, 8:00 AM - 12:00 PM

Salon E

**POSTERS WILL BE ON DISPLAY IN SALON F FOR THE FOLLOWING:
COTTON ECONOMICS AND MARKETING CONFERENCE**

Cotton Agronomy, Physiology & Soil Conference Posters

- Influence of Various within Boll Yield Components on Lint Yield and Fiber Quality in Advanced Cotton Breeding Lines**
Gurpreet Virk, John L. Snider, Peng Chee, Simerjeet Virk, Navneet Kaur and Ved Parkash, University of Georgia, Tifton, GA
- Determination of Cotton Leafroll Dwarf Virus Induced Limitations to Photosynthesis and Yield of Cotton**
Ved Parkash¹, Divya Bhanu Sharma¹, John L. Snider¹, Sudeep Bag¹, Phillip Roberts¹, Afsha Tabassum¹, Dalton West¹, Sameer Khanal¹, Nelson Dias Suassuna² and Peng Chee¹, (1)University of Georgia, Tifton, GA, (2)Brazilian Agricultural Research Corporation - EMBRAPA, Santo Antonio de Goias - GO, Brazil
- Investigating the Rain-Free Period of Mepiquat Chloride as Impacted by Adjuvant, Rate, and Interval between Application and Simulated Rainfall**
Montana Hall, Caitlyn B Lawton and Lavesta C. Hand, University of Georgia, Tifton, GA
- Using Aerial Imagery to Optimize the Efficiency of PGR Application in Cotton**
Sayantan Sarkar, **Kurt Wedegaertner** and Avat Shekoofa, University of Tennessee, Jackson, TN
- Cultivar, Irrigation Management, and PGR Strategy: Effects on Cotton Growth, Maturity, and Yield.**
Devendra Prasad Chalise¹, John L. Snider¹, Lavesta C. Hand¹, George Vellidis¹, Lorena N. Lacerda¹, Alessandro Ermanis², Yafit Cohen³, Guy D. Collins⁴, Joshua M. Lee¹ and Amrit Pokhrel¹, (1) University of Georgia, Tifton, GA, (2)University of Padova, Legnaro, Italy, (3)Agricultural Research Organization (ARO), Bet-Dagan, Israel, (4)NC State University, Rocky Mount, NC
- Cotton Lint Loan Value as Influenced by ET in Split-Field Evaluation in Arkansas**
Bill Robertson and Joe N. Chiles, University of Arkansas System Division of Ag, Newport, AR
- Optimizing Management of Sprinkler Irrigated Cotton in a Degree Day Limited Environment**
Brenna A Cannon, Oklahoma State University, Stillwater, OK

Tuesday, January 4, 2022
Wednesday, January 5, 2022
Thursday, January 6, 2022

8. **Determining the Relationship between Growing Degree Days and Nodes Above White Flower to Predict Insecticide Termination**
Tyler S Soignier¹, Brian K. Pieralisi¹, Darrin M. Dodds², Eli B. Hobbs², Bradley Norris² and William Joseph Rutland¹, (1)Mississippi State University, Starkville, MS, (2)Mississippi State University, Mississippi State, MS
9. **Evaluating the Last Effective Bloom Date for Cotton in Georgia**
Brian W. Hayes¹, Jennifer T. Miller², Andy Carter³, Colton Scott Moon⁴, Guy Hancock⁵, Jackson C. Cloud⁶, Jay Porter⁷, Jeremy M. Kichler⁸, Jeremy Register⁹, Joshua Dawson¹⁰, Stephanie Hollifield¹¹, Phillip Roberts¹² and Lavesta C. Hand¹², (1)University of Georgia Cooperative Extension, Camilla, GA, (2)University of Georgia Cooperative Extension, Hazlehurst, GA, (3)University of Georgia, Valdosta, GA, (4)UGA Extension, Cochran, GA, (5)University of Georgia, Athens, GA, (6)University of Georgia Cooperative Extension, Cairo, GA, (7)University of Georgia, Hawkinsville, GA, (8)University of Georgia Cooperative Extension, Moultrie, GA, (9) UGA Cooperative Extension, Vienna, GA, (10)UGA Cooperative Extension Service - Lowndes County, Valdosta, GA, (11)University of Georgia, Quitman, GA, (12)University of Georgia, Tifton, GA
10. **Impact of Harvest Aid Application Timing on Boll Opening, Yield, and Fiber Quality**
Wyatt Medina¹, Cayden B. Catlin¹, Bradley R Wilson², Andrea J Althoff¹, Trace Holsted¹, Bobby Weidenmaier³ and Seth A. Byrd¹, (1)Oklahoma State University, Stillwater, OK, (2)University of Missouri, Portageville, MO, (3)Oklahoma State University, Fort Cobb, OK
11. **Seeing, Knowing, Doing: Changing Paradigms in Crop Phenotyping**
Glen Ritchie, Department of Plant & Soil Science, Texas Tech University, Lubbock, TX and Irish Lorraine B Pabuayon, Texas Tech University, Lubbock, TX
12. **Genotypic Variation in Thermotolerance of Thylakoid Component Processes for Diverse Cotton Genotypes**
Navneet Kaur¹, John L. Snider¹, Andrew Paterson² and Gurpreet Virk¹, (1)University of Georgia, Tifton, GA, (2)College of Agricultural and Environmental Sciences, The University of Georgia, Athens, GA
13. **Genotype-By-Environment Interaction Effects on Morphological and Physiological Traits of Modern and Obsolete Cotton Cultivars across Southern Cotton Belt.**
Akanksha Sehgal¹, John L. Snider², Haydee E Laza³, Wenxuan Guo⁴, Gurpreet Kaur¹ and Daryl Chastain⁵, (1)Mississippi State University, Stoneville, MS, (2)University of Georgia, Tifton, GA, (3) Texas Tech, Lubbock, TX, (4)Department of Plant and Soil Science, Texas Tech University, Lubbock, TX, (5)USDA-National Center for Alluvial Aquifer Research, Leland, MS

14. **2021 UGA Cotton on-Farm Variety Evaluation Program Preliminary Results**
Lavesta C. Hand¹, Chandler Rowe¹, Holly Anderson², John Bennett³, Derrick Bowen⁴, Cody Bowling⁵, D. Scott Carlson⁶, Andy Carter⁷, Blake Carter⁸, Jackson C. Cloud⁹, Jeff Cook¹⁰, Joshua Dawson¹¹, Jason D. Edenfield¹², Phillip Edwards¹³, Ross Greene¹⁴, Guy Hancock¹⁵, Brian W. Hayes¹⁶, Jeremy M. Kichler¹⁷, Jason E. Mallard¹⁸, Seth Thomas McAllister¹⁹, Jennifer T. Miller²⁰, Jay Porter²¹, Cody Powell²², Tucker Price¹⁵, Lucy Ray²³, Ben Reeves²⁴, Pam Sapp¹, Peyton Sapp²⁵, Aubry Shirley⁴, Bill Starr²⁶, William G. Tyson²⁷, Madison Warbington²⁸, Anthony Black²⁹, Eric Elsner³⁰ and Scott Rogers³¹, (1)University of Georgia, Tifton, GA, (2)University of Georgia Cooperative Extension, Fitzgerald, GA, (3)University of Georgia, Rochelle, GA, (4)University of Georgia, Reidsville, GA, (5) University of Georgia, Donalsonville, GA, (6)University of Georgia Cooperative Extension, Sylvester, GA, (7)University of Georgia, Valdosta, GA, (8)University of Georgia Cooperative Extension, Rincon, GA, (9)University of Georgia Cooperative Extension, Cairo, GA, (10)University of Georgia, Fort Valley, GA, (11)UGA Cooperative Extension Service - Lowndes County, Valdosta, GA, (12)UGA Cooperative Extension Service - Toombs County, Lyons, GA, (13)University of Georgia Cooperative Extension, Ocilla, GA, (14)University of Georgia, Claxton, GA, (15)University of Georgia, Athens, GA, (16)University of Georgia Cooperative Extension, Camilla, GA, (17)University of Georgia Cooperative Extension, Moultrie, GA, (18)University of Georgia Cooperative Extension, Portal, GA, (19)University of Georgia Cooperative Extension, Dawson, GA, (20)University of Georgia Cooperative Extension, Hazlehurst, GA, (21)University of Georgia, Hawkinsville, GA, (22) University of Georgia, Colquitt, GA, (23)University of Georgia Cooperative Extension, Madison, GA, (24)University of Georgia, Nashville, GA, (25)University of Georgia Cooperative Extension, Waynesboro, GA, (26)The University of Georgia, Athens, GA, (27) University of Georgia Cooperative Extension, Statesboro, GA, (28) University of Georgia, Oglethorpe, GA, (29)University of Georgia, Midville, GA, (30)University of Georgia, Watkinsville, GA, (31) University of Georgia, Plains, GA
15. **Cotton Variety Performance in Mississippi**
Bradley Norris¹, Brian K. Pieralisi², Darrin M. Dodds¹, William Joseph Rutland², Tyler S Soignier² and Eli B. Hobbs¹, (1)Mississippi State University, Mississippi State, MS, (2)Mississippi State University, Starkville, MS
16. **2021 Mississippi on-Farm Cotton Variety Trials**
Brian K. Pieralisi¹, William Joseph Rutland¹, Bradley Norris², Eli B. Hobbs² and Tyler S Soignier¹, (1)Mississippi State University, Starkville, MS, (2)Mississippi State University, Mississippi State, MS
17. **Evaluation of Cotton in Large-Plot on-Farm Variety Testing in Arkansas**
Joe McAlee and Bill Robertson, University of Arkansas System Division of Ag, Newport, AR
18. **University of Tennessee Large Plot Variety Testing**
Tyson B Raper¹, Ryan Blair¹, **Matthew Drake Davis**¹, Lindsay Stephenson², Jake Mallard¹ and Becky Muller¹, (1)University of Tennessee, Jackson, TN, (2)University of Tennessee, Brownsville, TN

19. **2021 Texas Upper Gulf Coast Replicated Agronomic Cotton Evaluation (RACE) - Trial Summary**
Dale A. Mott¹, Benjamin M. McKnight², Corrie Bowen³, Kate Harrell-Crumley³, Mike Hiller⁴ and Laramie Kettler⁵, (1)Texas A&M AgriLife Extension Service, College Station, TX, (2)Texas A&M University, College Station, TX, (3)Texas A&M AgriLife Extension Service, Wharton, TX, (4)Texas A&M Agrilife Extension Service, Edna, TX, (5)Texas A&M AgriLife Extension Service, Columbus, TX
20. **Upland Cotton Variety Evaluation Trails on the Southern High Plains of Texas**
Brooke E Shumate, Texas A&M AgriLife, Lubbock, TX, Brendan Kelly, Texas A&M Agrilife Research, Lubbock, TX and Murilo Maeda, Texas A & M AgriLife Research, Lubbock, TX
21. **Northeast Texas 2021 Cotton Variety Evaluation**
David R. Drake, Texas A&M AgriLife Extension Service, Commerce, TX
22. **Replicated Agronomic Cotton Evaluation (RACE) Trial in the Rolling Plains of Texas-2021**
Jonathan H. Ramirez and Emi Kimura, Texas A&M AgriLife Research and Extension Service, Vernon, TX
23. **Stand Counts and Variety Performance in Oklahoma Large Plot Trials**
Trace Holsted¹, Bradley R Wilson², Cayden B. Catlin¹, Andrea J Althoff¹, Wyatt Medina¹ and Seth A. Byrd¹, (1)Oklahoma State University, Stillwater, OK, (2)University of Missouri, Portageville, MO
24. **Impact of Blending Various Proportions of Planting Seed of High-Yielding Upland and High-Quality Pima Cotton Genotypes in South Carolina**
Michael A. Jones¹, B. Todd Campbell² and Sarah K. Holladay¹, (1) Clemson University, Florence, SC, (2)USDA-ARS, Florence, SC
25. **Impact of Mixing Two Varieties on Yield, Fiber Quality, and Net Returns in Georgia**
Ben Reeves, University of Georgia, Nashville, GA, Jeremy M. Kichler, University of Georgia Cooperative Extension, Moultrie, GA, Colton Scott Moon, UGA Extension, Cochran, GA, William G. Tyson, University of Georgia Cooperative Extension, Statesboro, GA, Yangxuan Liu, Extension Economists, Department of Agricultural & Applied Economics, Tifton, GA and Lavesta C. Hand, University of Georgia, Tifton, GA
26. **Re-Visiting the Skip-Row Concept and 72-Inch Row Systems for NC Cotton**
Guy D. Collins¹, Keith L. Edmisten², Charlie Cahoon², Mitchell K Williams³ and Rachel A. Vann², (1)NC State University, Rocky Mount, NC, (2)North Carolina State University, Raleigh, NC, (3) North Carolina State University, Sanford, NC
27. **Impacts of Wide Row Spacings on Yield Components of Cotton**
Caitlyn B Lawton, John L. Snider, Phillip Roberts, Peng Chee and Lavesta C. Hand, University of Georgia, Tifton, GA

Tuesday, January 4, 2022
Wednesday, January 5, 2022
Thursday, January 6, 2022

28. **Upland Cotton Response to Different Management Practices in the Texas Southern High Plains**
Rebekah A Ortiz and Murilo Maeda, Texas A&M AgriLife Extension, Lubbock, TX
29. **Second Year Results for Seeding Rate Studies in Cotton in Alabama**
Steve M Brown, Dalton E Barber and Samuel A Frazier, Auburn University, Auburn University, AL
30. **Optimizing Seeding Rates of Upland Cotton to Maximize Profitability in Central Georgia**
Colton Scott Moon, UGA Extension, Cochran, GA
31. **Effect of Planting Dates, Cotton Varieties and Seeding Rates on Lint Yield and Fiber Quality**
Emi Kimura and Jonathan H. Ramirez, Texas A&M AgriLife Research and Extension Service, Vernon, TX
32. **Investigating Soil Compaction in Mid-South No-till Cotton Production**
Patricia de Sousa Soares¹, Lori Duncan², Tyson B Raper¹, Matthew Drake Davis¹ and Caden Johnson¹, (1)University of Tennessee, Jackson, TN, (2)University of Tennessee, Knoxville, TN
33. **Greenhouse Gas Emissions and Global Warming Potential of an Organic Cotton System**
Sk Musfiq Us Salehin¹, Nithya Rajan¹, Kenneth Casey², Noriki Miyataka¹, Peter Tomlinson³, Jake Mowrer⁴ and Muthu Bagavathiannan¹, (1)Texas A&M University, College Station, TX, (2)Texas A&M Agrilife Research, Amarillo, TX, (3)Kansas State University, Manhattan, KS, (4)Texas A&M AgriLife Extension Service, College Station, TX
34. **Using Soil Moistures Sensors in Cover Crops to Determine the Efficacy of Using Winter Cover in Northwestern Florida**
Libbie Johnson, University of Florida Escambia County, Cantonment, FL, Ethan Carter, University of Florida Jackson County, Marianna, FL and **Michael J. Mulvaney**, University of Florida, Jay, FL
35. **Evaluation of Cover Crop Influence on Potassium Uptake Dynamics in the Southeastern Cotton Belt**
Eli B. Hobbs¹, Tyler S Soignier¹, Darrin M. Dodds², Brian K. Pieralisi¹, Angus Catchot², Justin McCoy³, Hunter Perry⁴, William Joseph Rutland¹ and Bradley Norris², (1)Mississippi State University, Starkville, MS, (2)Mississippi State University, Mississippi State, MS, (3)Mississippi State Univ, Verona, MS, (4)Corteva Agriscience, Leland, MS
36. **The Effects of Biomass Production of Small Grains Winter Cover Species on Cotton Growth and Yield**
Bradley R Wilson¹, Seth A. Byrd², Jason Warren², Bobby Weidenmaier³, Cayden B. Catlin² and Andrea J Althoff², (1)University of Missouri, Portageville, MO, (2)Oklahoma State University, Stillwater, OK, (3)Oklahoma State University, Fort Cobb, OK
37. **Impact of Cover Crops Seeding Rate and Biomass Production on Dryland Lint Yields**
Charles Coufal¹, Paul DeLaune¹, Anthony Pennartz¹ and Emi Kimura², (1)Texas A&M AgriLife Research, Vernon, TX, (2)Texas A&M AgriLife Research and Extension Service, Vernon, TX

Tuesday, January 4, 2022
Wednesday, January 5, 2022
Thursday, January 6, 2022

38. **Cover Crop and Tillage Effects on Windmillgrass Control**
 Anthony Pennartz¹, **Paul DeLaune**¹, Charles Coufal¹ and Emi Kimura², (1)Texas A&M AgriLife Research, Vernon, TX, (2)Texas A&M AgriLife Research and Extension Service, Vernon, TX
39. **Inhibitions of Cotton and Pigweed Germination and Early Growth by Cover Crops Leachates**
Kendall Sheldon¹, Christian Baker¹, Avat Shekoofa¹, Larry Steckel¹, Virginia R Sykes¹ and Gaylon Morgan², (1)University of Tennessee, Jackson, TN, (2)Cotton Incorporated, Cary, NC
40. **Cotton Resource Partitioning: Leeways and Limitations**
Irish Lorraine B Pabuyan, Texas Tech University, Lubbock, TX and Glen Ritchie, Department of Plant & Soil Science, Texas Tech University, Lubbock, TX
41. **Effect of Various Foliar Potassium Sources and Rates on Foliar Potassium Concentrations, Lint Yield and Fiber Quality**
D. T Mays¹, Dale A. Mott², Zach T Davis¹ and Benjamin M. McKnight³, (1)Texas A&M AgriLife Extension Service, Hillsboro, TX, (2)Texas A&M AgriLife Extension Service, College Station, TX, (3)Texas A&M University, College Station, TX
42. **Nutrient Drawdown Impact on Yield in a Long Term Cotton Fertility Study in Southwest Oklahoma**
Raedan L Sharry and Brian Arnall, Oklahoma State University, Stillwater, OK
43. **Optimizing Nitrogen Management in Dryland Cotton Using Precision Agriculture Technologies in the Southern High Plains**
 Rupak Karn¹, **Wenxuan Guo**², Katie L. Lewis³, Sanjit Deb⁴, Glen Ritchie⁴ and Chenggang Wang⁵, (1)Texas Tech University, Lubbock, TX, (2)Department of Plant and Soil Science, Texas Tech University, Lubbock, TX, (3)Texas A&M AgriLife Research and Extension Center, Lubbock, TX, (4)Department of Plant & Soil Science, Texas Tech University, Lubbock, TX, (5)Department of Agricultural and Applied Economics, Texas Tech University, Lubbock, TX
44. **Refinement of Nitrogen Recommendations for Cotton in Central Texas**
Joshua M Doria, Texas A&M AgriLife Research, College Station, TX, Julie A. Howe, Texas AgriLife Research, College Station, TX, Benjamin M. McKnight, Texas A&M University, College Station, TX and Katie L. Lewis, Texas A&M AgriLife Research and Extension Center, Lubbock, TX

Cotton Disease Council Posters

45. **Influence of Reniform Nematodes on Cotton Cultivars and the Benefit of Adding a Nematicide.**
Bisho Ram Lawaju¹, Marina Nunes Rondon¹, Ashton Kate Turner¹, Drew Schrimsher² and Kathy Lawrence¹, (1)Auburn University, Auburn, AL, (2)Agri-AFC, LLC, Decatur, AL
46. **Genotypic and Pathogenic Characterization of FOV Race 3 (VCG0113) and Race 3 like Isolates from Cotton**
Jinggao Liu¹, Alois A. Bell¹ and Tanya A Wagner², (1)USDA-ARS ICCDRU, College Station, TX, (2)USDA-ARS-ICCDRU, College Station, TX

47. **Cotton Cultivar Disease Incidence, Severity, and Yields When Challenged with Verticillium Wilt in the Tennessee Valley Region, 2021**
Kathy S Lawrence¹, Tyler Sandlin², Andy Page³, Tyson B Raper⁴, Heather M Kelly⁴, Brad Meyer⁵ and Nathan Silvey⁶, (1)Auburn University, Auburn University, AL, (2)Auburn University, Belle Mina, AL, (3)Auburn University, Auburn, AL, (4)University of Tennessee, Jackson, TN, (5)GreenPoint AG, Decatur, AL, (6)Madison County Co-op, Decatur, AL
48. **Disecting the Genome Structure of Fov4 and Diversity within the Species Complex**
Catherine Danmaigona Clement, Texas A&M University, College Station, TX
49. **Screening Cotton Cultivars for Resistance to the Fusarium Wilt Disease Complex with Fusarium Oxysporum f. Sp. Vasinfectum (race 1 and 2) and Meloidogyne Incognita**
Jessica Dotray, Texas Tech University, Lubbock, TX, Terry A. Wheeler, Texas A&M AgriLife Research, Lubbock, TX and Cecilia Monclova-Santana, Texas A&M AgriLife Extension, Lubbock, TX
50. **Relative Performance of Varieties Resistant to Root-Knot and Reniform Nematodes in the Presence of Root-Knot, Columbia Lance and Lesion Nematodes**
Saleh M. Ahmed, Michael T. Plumblee and John Mueller, Clemson University, Blackville, SC
51. **Effect of Rotation on Rotylenchulus reniformis Nematode Populations in Using Cotton Cultivars in West Texas.**
Casiani Marie Soto-Ramos, Texas Tech University, Lubbock, TX, Terry Wheeler, Texas A&M AgriLife Research, Lubbock, TX and Cecilia Monclova-Santana, Texas A&M AgriLife Extension, Lubbock, TX
52. **Evaluation of Nematicides and Resistant Cultivar Combinations for Reniform Nematode Management in Mississippi Cotton**
Tessie H. Wilkerson, Mississippi State University, Mississippi State, MS, Thomas W. Allen, Mississippi State University, Delta Research and Extension Center, Stoneville, MS, Daryl Chastain, USDA-National Center for Alluvial Aquifer Research, Leland, MS, Sally Stetina, USDA-ARS, Stoneville, MS, Jack C. McCarty, USDA-ARS, Mississippi State, MS and Nicholus Tadlock, Mississippi State University-Delta Research and Extension Center, Stoneville, MS
53. **Management of Reniform Nematode in Mississippi with Phytogen Cultivars and Seed Treatment Combinations**
Tessie H. Wilkerson, Mississippi State University-Delta Research and Extension Center, Stoneville, MS, Thomas W. Allen, Mississippi State University, Delta Research and Extension Center, Stoneville, MS and Thomas Eubank, Corteva Agriscience, Leland, MS
54. **Seven Seasons of Foliar Fungicide Trials in Louisiana Cotton**
Paul Price, Myra A Purvis and Dustin Ezell, LSU AgCenter, Winnsboro, LA

Tuesday, January 4, 2022
Wednesday, January 5, 2022
Thursday, January 6, 2022

55. **Cotton Disease Loss Estimate Committee Report, 2021**
Kathy S Lawrence, Auburn University, Auburn University, AL, Amanda Strayer-Scherer, Auburn University, Auburn, AL, Randy Norton, University of Arizona, Safford, AZ, Jiahuai Hu, University of Arizona, Tucson, AZ, Travis R. Faske, University of Arkansas Division of Agriculture, Lonoke, AR, Robert Hutmacher, University of California, Shafter, CA, John Muller, Clemson University, Blackville, SC, Ian Small, University of Florida, Quincy, FL, Zane J. Grabau, University of Florida, Gainesville, FL, Robert Kemerait, University of Georgia, Tifton, GA, Doug Jardine, Kansas State University, Manhattan, KS, Paul Price, LSU AgCenter, Winnsboro, LA, Tristan Watson, LSU AgCenter, Baton Rouge, LA, Thomas W. Allen, Mississippi State University, Delta Research and Extension Center, Stoneville, MS, Calvin D Meeks, University of Missouri, Portageville, MO, John Idowu, New Mexico State University, Las Cruces, NM, Lindsey D. Thiessen, NC State University, Raleigh, NC, Seth A. Byrd, Oklahoma State University, Stillwater, OK, Jerry Goodson, OSU Southwest Research and Extension Center, Altus, OK and Heather M Kelly, University of Tennessee, Jackson, TN
56. **Cultivar Response to Inoculation with *Xanthomonas citri* Subsp. *Malvacearum* in Mississippi in 2021**
Thomas W. Allen, Mississippi State University, Delta Research and Extension Center, Stoneville, MS
57. **Report of the Cottonseed Treatment Committee for 2021**
Heather M Kelly¹, **Rachel R. Guyer**¹, Akhtar Ali², Thomas W. Allen³, Tessie H. Wilkerson⁴, Robert Kemerait⁵, Kathy Lawrence⁶, Cecilia Monclova-Santana⁷, Paul Price⁸, Alejandro Rojas⁹, Ian Small¹⁰, Terry Spurlock¹¹ and Amanda Strayer-Scherer⁶, (1)University of Tennessee, Jackson, TN, (2)Department of Biological Science, The University of Tulsa, Tulsa, OK, (3)Mississippi State University, Delta Research and Extension Center, Stoneville, MS, (4)Mississippi State University, Mississippi State, MS, (5)University of Georgia, Tifton, GA, (6)Auburn University, Auburn, AL, (7)Texas A&M AgriLife Extension, Lubbock, TX, (8)LSU AgCenter, Winnsboro, LA, (9) University of Arkansas, Fayetteville, AR, (10)University of Florida, Quincy, FL, (11)University of Arkansas, Monticello, AR
58. **A Novel and Efficient Method for Identifying Cotton Leafroll Dwarf Virus (CLRDV) Infection in Upland Cotton (*Gossypium hirsutum*)**
Serina M Taluja, Texas A&M University, College Station, TX

Cotton Engineering-Systems Conference Posters

59. **Development and Evaluation of a Weed Sensing Automated Tactical Tillage Tool to Control Weeds in Row-Crop Production Systems**
Grace M. Friday¹, John Wesley Lowe², Gary Daniel Chess-er, Jr.¹ and Brian K. Pieralisi³, (1)Mississippi State University Agricultural & Biological Engineering, Mississippi State, MS, (2) Mississippi State University, Mississippi State, MS, (3)Mississippi State University, Starkville, MS
60. **University of Tennessee Cotton Microgin**
Tyson B Raper, **Caden Johnson**, Ryan Blair and Matthew Drake Davis, University of Tennessee, Jackson, TN

Tuesday, January 4, 2022
Wednesday, January 5, 2022
Thursday, January 6, 2022

61. **From Variety Trials and On-Farm Data to Variety Productivity Validation: Framework to Incorporate On-Farm Data Towards Variety Productivity Prediction**
Raul Sebastian Martinez, Texas A&M University, College Station, TX
62. **Characterization of Spatial Herbicide Injury Patterns in Cotton Using Aerial Imagery**
Ubaldo Torres¹, Bishwa Sapkota¹, Benjamin M. McKnight¹, Scott Nolte¹, Gaylon Morgan², Peter A. Dotray³ and Muthukumar V Bagavathiannan¹, (1)Texas A&M University, College Station, TX, (2)Cotton Incorporated, Cary, NC, (3)Texas Tech University, Texas A&M AgriLife Research and Extension Service, Lubbock, TX
63. **Cloud Based Data Management for Growth Analysis**
Jose L Landivar¹, Juan Landivar¹, Mahendra Bhandari¹, Daniel Gonzalez² and Anjin Chang³, (1)Texas A&M AgriLife Research, Corpus Christi, TX, (2)Texas A&M Agrilife Research and Extension Center, Corpus Christi, TX, (3)Texas A&M University - Corpus Christi, Corpus Christi, TX
64. **UAV Development Towards Agriculture**
Daniel Gonzalez, Texas A&M Agrilife Research and Extension Center, Corpus Christi, TX

Cotton Ginning Conference Posters

65. **Big Data Approaches to Model Gin Function**
John Gottula¹, Adam Hillman¹, David Blakemore², Harrison Ashley³, Robert G. Hardin⁴, Joe W. Thomas⁵, Christopher D. Delhom⁶, Derek P. Whitelock⁷, Gregory A. Holt⁸ and Edward M. Barnes⁹, (1) SAS Institute, Cary, NC, (2)Blakemore Cotton & Grain, Campbell, MO, (3)National Cotton Council, Cordova, TN, (4)Texas A&M University, College Station, TX, (5)USDA ARS, Stoneville, MS, (6) USDA-ARS, New Orleans, LA, (7)USDA-ARS Southwestern Cotton Ginning Research Laboratory, Mesilla Park, NM, (8)USDA-ARS Cotton Production and Processing Research Unit, Lubbock, TX, (9)Cotton Incorporated, Cary, NC

Cotton Improvement Conference Posters

66. **Effects of Leaf and Bract Pubescence on Fiber Quality of Normal and Okra Leaf Cotton**
Bradley R Wilson, University of Missouri, Portageville, MO, Jane K Dever, Texas A&M AgriLife Research and Extension Center, Lubbock, TX, Carol Mason Kelly, Texas A&M AgriLife Research, Lubbock, TX, Steve Hague, Texas A&M University, College Station, TX and Seth A. Byrd, Oklahoma State University, Stillwater, OK
67. **Evaluation of N Rate and Timing of Application across Differing Climates**
Michaela Smith¹, Raedan L Sharry¹, Vaughn L Reed¹, Bronc Finch², Hunter Lovewell² and Brian Arnall¹, (1)Oklahoma State University, Stillwater, OK, (2)Oklahoma State (Agriculture Hall), Stillwater, OK
68. **Status of the National Cotton Germplasm Collection**
James Frelichowski¹, Janna Love¹, Lori Hinze¹, Joshua Udall¹, Don C Jones² and Jodi Scheffler³, (1)USDA-ARS, College Station, TX, (2)Cotton Incorporated, Cary, NC, (3)USDA ARS, Stoneville, MS

Tuesday, January 4, 2022
Wednesday, January 5, 2022
Thursday, January 6, 2022

69. **Effect of Growth Stage, Cotton Genotype, and Root Wounding on Disease Development of Fusarium Wilt Caused by *Fusarium Oxysporum* f. *Sp. Vasinfectum* Race 4**
Yi Zhu¹, Heather Arce², Jane K Dever³, Terry A. Wheeler⁴, Kater Hake⁵, Tom Wedegaertner⁵ and Jinfa Zhang¹, (1)New Mexico State University, Las Cruces, NM, (2)Texas A&M AgriLife Research, El Paso, TX, (3)Texas A&M AgriLife Research and Extension Center, Lubbock, TX, (4)Texas A&M AgriLife Research, Lubbock, TX, (5) Cotton Incorporated, Cary, NC
70. **Deltapine Class of 22 Upland Cotton Varieties**
David W Albers, Bayer Crop Science, St. Louis, MO, Eric Best, Bayer Crop Science, Lubbock, TX and Keylon Gholston, Bayer Crop Science, Baldwin, MS

Cotton Insect Research and Control Conference Posters

71. **Bt Cotton in Alabama: 25 Years Later**
Scott H. Graham, Auburn University, Auburn University, AL and Ron H. Smith, Auburn University, Auburn, AL
72. **2021 Cotton Insect Losses Estimates**
Don Cook, Mississippi State University, Stoneville, MS and Meg Threet, MSU, Stoneville, MS
73. **Development of a New Pheromone Dispenser for the Boll Weevil**
Charles P.-C. Suh, USDA-ARS ICCDRU, College Station, TX and Vincent Chebny, Trece Inc, Adair, OK
74. **Midsouth Cotton Response to Interactions of Cover Crop System and Cotton Seeding Rate with Early Season Thrips Control**
Tina Gray Teague¹, Amanda M. Mann², Andrew J. Baker², N. Ray Benson³ and John W. Nowlin⁴, (1)Ark State Univ / Univ Ark Sys Div of Ag, State University, AR, (2)University of Arkansas System Division of Agriculture, State University, AR, (3)University of Arkansas System Division of Agriculture, Osceola, AR, (4)Arkansas State University, State University, AR
75. **Monitoring Bollworm Flights in Arkansas - a Two Year Summary**
Courtney J Spinks and Glenn Studebaker, University of Arkansas, Keiser, AR
76. **Evaluation of Seed Treatments in Cotton to Control Tobacco Thrips, *Frankliniella fusca* (Hinds), in Mississippi**
Dung Bao¹, Angus Catchot², Don Cook³, Whitney Crow³, Jeff Gore³, Cori Speights¹ and Jacob Smith³, (1)Mississippi State University, Mississippi State, MS, (2)Mississippi State University, Starkville, MS, (3)Mississippi State University, Stoneville, MS
77. **Influence of Plant Architecture of Okra Leaf Cotton on Crop Microclimate, Solar Radiation and Helicoverpa Zea Egg Hatch**
Jane Pierce, Ivan Tellez and Patricia Monk, New Mexico State University, Las Cruces, NM
78. **Protocol for Screening for Aphid Resistance in Cotton**
Delaney Roark, Jenny Koebernick and Alana Lynn Jacobson, Auburn University, Auburn, AL

Tuesday, January 4, 2022
Wednesday, January 5, 2022
Thursday, January 6, 2022

79. **Evaluation of Insecticide Efficacy at Various Wash-Off Intervals**
Kyle Smith¹, Michael T. Plumblee² and Jeremy Greene², (1)Clemson University Edisto REC, Blackville, SC, (2)Clemson University, Blackville, SC

Cotton Utilization Conference Posters

80. **Detoxification and Fermentation of Dissolved Colored Discarded Cotton Fabrics**
K. Thomas Klasson, U.S. Department of Agriculture, New Orleans, LA and Matthew J. Farrell, Cotton Inc., Cary, NC

Cotton Weed Science Research Conference Posters

81. **Xtendflex and Enlist Cotton Tolerance to Glufosinate When Mixed with Glutathione S-Transferase Inhibitors and Saflufenacil**
Pamela Carvalho-Moore, Jason K Norsworthy, Maria Leticia Zaccaro-Gruener, Lawson Priess, Mason Castner and Leonard B Piveta, University of Arkansas, Fayetteville, AR
82. **Optimizing Fluazifop Applications for Johnsongrass Control**
Jacob A Fleming¹, Jason K Norsworthy¹, Michael M. Houston¹, Pamela Carvalho-Moore¹, Muthukumar V Bagavathiannan² and Tom Barber³, (1)University of Arkansas, Fayetteville, AR, (2)Texas A&M University, College Station, TX, (3)University of Arkansas-Extension, Lonoke, AR
83. **Longevity of Residual Palmer Amaranth Control with Preemergence-Applied Cotton Herbicides**
Lou Adams¹, Tom Barber², Jason K Norsworthy¹, Aaron Ross² and Ryan Doherty³, (1)University of Arkansas, Fayetteville, AR, (2)University of Arkansas-Extension, Lonoke, AR, (3)University of Arkansas Monticello, Monticello, AR
84. **Cotton Response to High Rates of Preemergence-Applied Acetochlor and Diuron on a Clay Soil**
Ty C Smith¹, Jason K Norsworthy¹, Casey H Arnold¹, Navdeep Godara¹ and Tom Barber², (1)University of Arkansas, Fayetteville, AR, (2)University of Arkansas-Extension, Lonoke, AR
85. **Use of Radio-Labeled Herbicides to Understand Interactions between Dicamba and Glufosinate**
Mason Castner¹, Jason K Norsworthy¹, Lawson Priess¹, Pamela Carvalho-Moore¹, Jeong I Hwang¹ and Thomas R Butts², (1)University of Arkansas, Fayetteville, AR, (2)University of Arkansas, Lonoke, AR
86. **Response of Difficult-to-Control Palmer Amaranth Accessions to Eleven Herbicide Groups**
Navdeep Godara¹, Jason K Norsworthy¹, Lawson Priess¹, Tom Barber² and Thomas R Butts³, (1)University of Arkansas, Fayetteville, AR, (2)University of Arkansas-Extension, Lonoke, AR, (3)University of Arkansas, Lonoke, AR
87. **Evaluation of Fomesafen Tank-Mixes in Oklahoma Cotton**
Zachary R. Treadway, Jennifer Dudak and Todd A Baughman, Oklahoma State University, Ardmore, OK

Tuesday, January 4, 2022
Wednesday, January 5, 2022
Thursday, January 6, 2022

88. **Crop Response and Control of Palmer Amaranth in HPPD-Tolerant Cotton Systems**
Maxwell E Smith, Texas Tech University, Lubbock, TX, Peter A. Dotray, Texas Tech University, Texas A&M AgriLife Research and Extension Service, Lubbock, TX and Adam Hixson, BASF, Lubbock, TX
89. **Integrating Alite 27 with Various Residual Cotton Herbicides**
Jennifer Dudak¹, Zachary R. Treadway¹, Todd A Baughman¹, Tom Barber², Charlie Cahoon³, Justin S Calhoun⁴, A. Stanley Culpepper⁵, Peter A. Dotray⁶, Michael W. Marshall⁷, Reagan L. Noland⁸, Scott Nolte⁹, Adam C Hixon¹⁰, Larry Steckel¹¹, Daniel O Stephenson IV¹² and Maxwell E Smith¹³, (1)Oklahoma State University, Ardmore, OK, (2)University of Arkansas-Extension, Lonoke, AR, (3) North Carolina State University, Raleigh, NC, (4)Mississippi State University, Mississippi State, MS, (5)University of Georgia, Tifton, GA, (6)Texas Tech University, Texas A&M AgriLife Research and Extension Service, Lubbock, TX, (7)Clemson University - Edisto REC, Blackville, SC, (8)Texas A&M Agrilife Extension Service, San Angelo, TX, (9)Texas A&M University, College Station, TX, (10) BASF, Lubbock, TX, (11)University of Tennessee, Jackson, TN, (12)LSU AgCenter, Alexandria, LA, (13)Texas Tech University, Lubbock, TX
90. **Palmer Amaranth Control Utilizing Finger Weeder Technology**
Blaine Patton, Texas Tech University, Lubbock, TX, Peter A. Dotray, Texas Tech University, Texas A&M AgriLife Research and Extension Service, Lubbock, TX, J. Wayne Keeling, Texas A&M AgriLife Research Center, Lubbock, TX and Gaylon Morgan, Cotton Incorporated, Cary, NC
91. **Chemical Gametocides Can Suppress Reproduction in Late-Season Palmer Amaranth (*Amaranthus palmeri*) Escapes**
Sarah E. Kezar¹, Nithya Subramanian¹, Gaylon Morgan² and Muthukumar V Bagavathiannan¹, (1)Texas A&M University, College Station, TX, (2)Cotton Incorporated, Cary, NC
92. **Cover Crops and Herbicides Integration for Weed Control in Cotton**
Annu Kumari, Auburn University, Auburn, AL and Andrew Price, USDA-ARS, National Soil Dynamics Unit, Auburn, AL
93. **Influence of Seed Size on Cotton Injury from Soil Applied Herbicides at Planting**
Sarah K. Holladay¹, Michael W. Marshall², Michael T. Plumblee³, Michael A. Jones¹ and Matthew D Inman¹, (1)Clemson University, Florence, SC, (2)Clemson University - Edisto REC, Blackville, SC, (3) Clemson University, Blackville, SC

Tuesday, January 4, 2022
Wednesday, January 5, 2022
Thursday, January 6, 2022

94. **Profitability and Risk Efficiency of Dicamba Based Herbicide Programs Under Crop Rotations and Tillage in Cotton**
Rohith Vulchi¹, Samuel D. Zapata², John R.C. Robinson³, Joshua McGinty⁴ and Scott Nolte³, (1)Texas A&M University, College Station, College Station, TX, (2)Texas A&M AgriLife Extension Service, Weslaco, TX, (3)Texas A&M University, College Station, TX, (4)Texas A&M AgriLife Extension Service, Corpus Christi, TX
95. **Palmer Amaranth Management with PRE Herbicides Alone or in Combination with Dicamba**
C.D. Ray White¹, J. Wayne Keeling², Peter A. Dotray³, Jourdan M. Bell⁴ and Kevin Heflin⁴, (1)Texas A&M AgriLife Research, Lubbock, TX, (2)Texas A&M AgriLife Research Center, Lubbock, TX, (3)Texas Tech University, Texas A&M AgriLife Research and Extension Service, Lubbock, TX, (4)Texas A&M AgriLife, Amarillo, TX
96. **Herbicide Programs in Enlist Cotton for Long-Term Glyphosate-Resistant Palmer Amaranth Control**
Taghi Bararpour, Mississippi State University, Stoneville, MS and David A Bell, Mississippi State University, MS State, MS
97. **Herbicide Programs in Xtend Cotton in the Absence of Xten-dimax, Fexapan, and Engenia for Long-Term Glyphosate-Resistant Palmer Amaranth Control**
David A Bell, Mississippi State University, MS State, MS and Taghi Bararpour, Mississippi State University, Stoneville, MS
98. **Herbicide Programs in Stoneville Cotton for Long-Term Glyphosate-Resistant Palmer Amaranth Control**
Jaret W Reister and Taghi Bararpour, Mississippi State University, Stoneville, MS
99. **Residual Activity of Direx, Caparol, Cotoran, Brake, Staple, Dual Magnum, Prowl, and Warrant on Glyphosate-Resistant Palmer Amaranth**
Taghi Bararpour¹, David A Bell², Jeff Gore¹, Thomas W. Allen³ and Tessie H. Wilkerson⁴, (1)Mississippi State University, Stoneville, MS, (2)Mississippi State University, MS State, MS, (3)Mississippi State University, Delta Research and Extension Center, Stoneville, MS, (4)Mississippi State University, Mississippi State, MS
100. **Herbicide Systems in Dicamba Cotton for Downwind Buffer Field Areas**
Michael W. Marshall, Clemson University - Edisto REC, Blackville, SC

Sustainability Posters

101. **Recent Progress on the Effects of Ingested Cotton and Synthetic Microfibers on Growth Performance and Intestinal Tissue Morphology in the Black Sea Bass, a Commercially Important Marine Finfish from Coastal Waters of the Eastern US.**
Austin M Schmidt, Wade O Watanabe, Md Shah Alam, Patrick M Carroll, Alison R Taylor and Carolina Priester, University of North Carolina Wilmington, Wilmington, NC
102. **Sustainable Agricultural Practices in the Southern High Plains**
Donna M McCallister, Texas Tech University, Lubbock, TX and Katie L. Lewis, Texas A&M AgriLife Research and Extension Center, Lubbock, TX

Tuesday, January 4, 2022
Wednesday, January 5, 2022
Thursday, January 6, 2022

103. **Soil Water Depletion and Recharge Following Cover Crop Use in Texas Cotton Production**
Joseph Alan Burke, Texas A&M AgriLife Research, Lubbock, TX, Katie L. Lewis, Texas A&M AgriLife Research and Extension Center, Lubbock, TX, Paul DeLaune, Texas A&M AgriLife Research, Vernon, TX and J. Wayne Keeling, Texas A&M AgriLife Research Center, Lubbock, TX
104. **The Impact of Tillage and Cover Crops on Cotton Yield, Water Use Efficiency, and Runoff**
Carson Roberts¹, Drew Gholson¹, Martin Locke² and Dave Spencer³, (1)Mississippi State University, Stoneville, MS, (2) USDA-ARS, Oxford, MS, (3)Mississippi State University, Mississippi State, MS
105. **Economic Benefits of Water Savings with No-Tillage and Cover Crops in Semi-Arid Texas Cotton Production**
Christopher Cobos¹, Joseph Alan Burke¹, Donna McCallister², Will Keeling³, J. Wayne Keeling², Paul DeLaune⁴ and Katie L. Lewis⁵, (1)Texas A&M AgriLife Research, Lubbock, TX, (2)Texas A&M AgriLife Research Center, Lubbock, TX, (3)Texas A&M AgriLife Extension, Lubbock, TX, (4)Texas A&M AgriLife Research, Vernon, TX, (5)Texas A&M AgriLife Research and Extension Center, Lubbock, TX
106. **Evaluation of Reduced Inputs Facilitated by Improving Soil Health in Cotton Yield and Profitability**
Bill Robertson and Joe McAlee, University of Arkansas System Division of Ag, Newport, AR
107. **Environmental Sustainability Impacts of Cover Crops in Southeastern Cotton Production**
Madison G Harkins¹, Yangxuan Liu², Alejandro Plastina³, Guy Hancock⁴, Amanda R Smith², Nick D McGhee⁵, Wesley M Porter¹ and A. Stanley Culpepper¹, (1)University of Georgia, Tifton, GA, (2)Extension Economists, Department of Agricultural & Applied Economics, Tifton, GA, (3)Iowa State University, Ames, IA, (4) University of Georgia, Athens, GA, (5)USDA NRCS, Americus, GA
108. **Evaluation of Cover Crop Termination Timings and Methods in Cotton Production Systems**
Savana D Denton, Tyson B Raper and Cheyenne W Rushing, University of Tennessee, Jackson, TN
109. **Cotton Research Verification Sustainability Program: Economic Report**
Bill Robertson¹, Amanda Free¹, Joe McAlee¹ and Breana Watkins², (1)University of Arkansas System Division of Ag, Newport, AR, (2)University of Arkansas System Division of Ag, Little Rock, AR
110. **Cotton Research Verification Sustainability Program: Sustainability Report**
Bill Robertson¹, Amanda Free¹, Joe McAlee¹ and Breana Watkins², (1)University of Arkansas System Division of Ag, Newport, AR, (2)University of Arkansas System Division of Ag, Little Rock, AR

Tuesday, January 4, 2022
Wednesday, January 5, 2022
Thursday, January 6, 2022

111. **Improving Sustainability: Program to Demonstrate Implementation and Benefits of the U.S. Cotton Trust Protocol and Better Cotton Initiative Better Cotton Program**
Bill Robertson¹, Joe McAlee¹, Matt Fryer², Amanda Free¹, Karen Wynne³, Andrew Jordan⁴, Jesse Daystar⁵, Steven Pires⁵ and Bruce Kirksey⁶, (1)University of Arkansas System Division of Ag, Newport, AR, (2)University of Arkansas System Division of Ag, Little Rock, AR, (3)Better Cotton Initiative, Huntsville, AL, (4)Jordan Associates Ag and Bio Engineering Services, Cordova, TN, (5)Cotton Incorporated, Cary, NC, (6)Agricenter International, Memphis, TN
112. **Using the Field to Market Fieldprint Calculator to Establish Trends in Cotton and Peanut Sustainability Metrics**
Kaylyn Groce and Wesley M Porter, University of Georgia, Tifton, GA
113. **Greenhouse Gas Emission Accounting in Cotton Production: Significance of Year-Around Carbon Budget**
Nithya Rajan, Texas A&M University, College Station, TX

Recorded Presentations

The Beltwide Cotton Conferences (BWCC) continue the tradition of putting leading edge information and innovations into attendees' hands to help with decision-making. The full 2022 BWCC Proceedings are scheduled to be mailed in May to attendees who purchase them. However, many of the forum's reports—gleaned from the Confex Podium presentation management/ recording service—are available online.*

The National Cotton Council is pleased to make these presentations available to the cotton industry through the Confex Podium web site. To view presentations on the computer, all that is needed is a high-speed Internet connection.

These can be viewed by selecting the Recorded Presentations tab at the BWCC website home page, www.cotton.org/beltwide or use this QR Code.



Session Example: After clicking on the recording link, select program and click on a session of interest. Next, scroll down to a presentation you want to listen to and click. The presentation you selected will be downloaded to your computer. (Note: first time users may need to download some additional software to hear and see the selected presentation.)

**The Confex Podium presentation service has been available to Beltwide speakers and attendees since the 2006 BWCC. The primary goal is to enable attendees timely access to a wide range of conference presentations prior to the published proceedings - including reports they did not hear at the conferences and reports they did hear but want to review.*

Wi-Fi

Address: Beltwide Wi-Fi

Password: beltwide2022

Notes

Notes

Notes

Notes



2023 Beltwide Cotton Conferences

January 10-12 · New Orleans, Louisiana
New Orleans Marriott Hotel

New Orleans

2022 Beltwide Sponsors



**Confex Podium
Registration
New Developments From Industry
Consultants Conference**
<https://www.cropscience.bayer.com>



Final Program
<https://farmcredit.com>



Consultants Conference
<https://www.basf.com/us/en.html>



**Consultants Conference
New Developments From Industry**
<https://www.syngenta.com>



Consultants Conference
<http://www.fmc.com/>



Consultants Conference
<https://www.corteva.com>



Cotton Ginning Conference
<https://www.tama-usa.com>



**Cotton Sustainability Conference
Cotton Weed Conference**
<https://www.valent.com>



JOHN DEERE

**Cotton Agronomy, Physiology, and Soil Conference
Cotton Engineering - Systems Conference
Cotton Quality Conference**
<https://deere.com>



Special thanks to the **GEORGIA FARM BUREAU** for providing the peanuts in the registration area.

<http://www.gfb.org>